

WEAVER[®]

LIFTING SYSTEMS SINCE 1910

SPACE MISER AFH-88 AFH-88W

INSTALLATION INSTRUCTIONS AND SERVICE PARTS LIST (TWO-POST SURFACE MOUNTED HYDRAULIC LIFT)

PANZITTA SALES & SERVICE

72 George Avenue

Wilkes-Barre, PA 18705

570-822-6720 800-822-6720

www.panzittasales.com

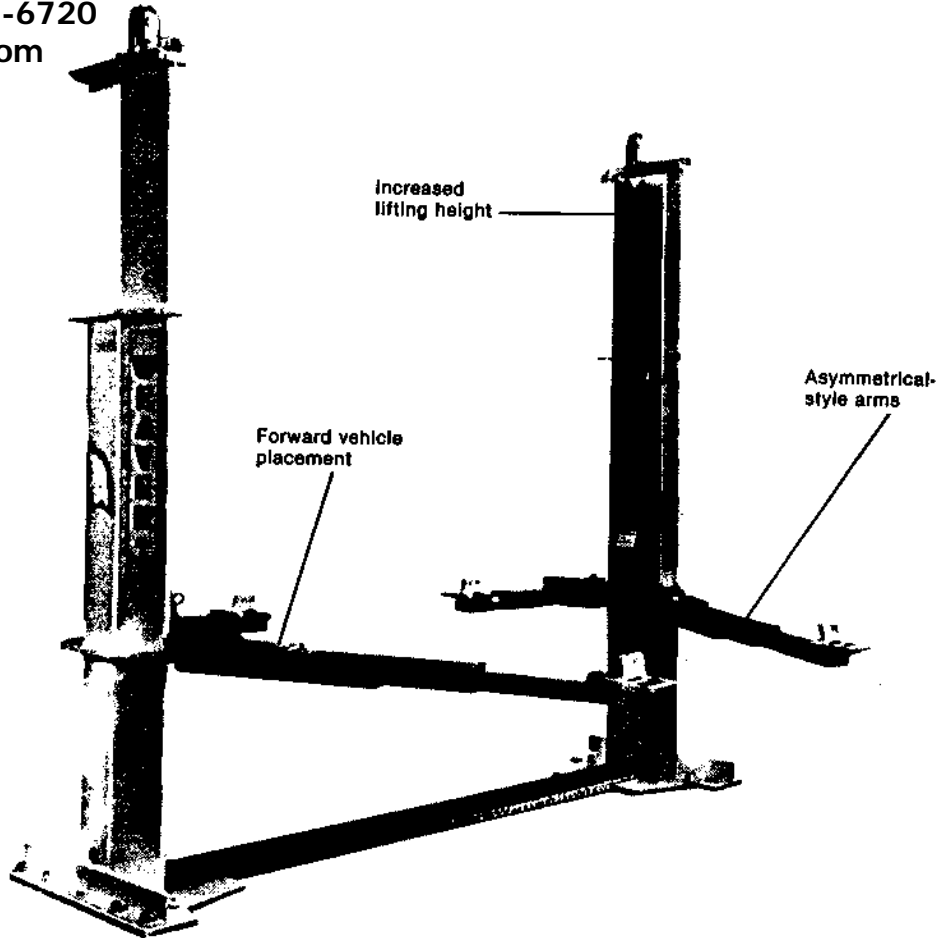

CAPACITY: 7000 lbs.

These automotive lifts comply with all requirements of the current American ANSI B153.1, as issued by the American National Standards Institute.

MODEL NO. _____

INSTALLER _____

SERIAL NO. _____

DATE INSTALLED _____

PANZITTA SALES & SERVICE
72 George Avenue
Wilkes-Barre, PA 18705
570-822-6720 800-822-6720
www.panzittasales.com

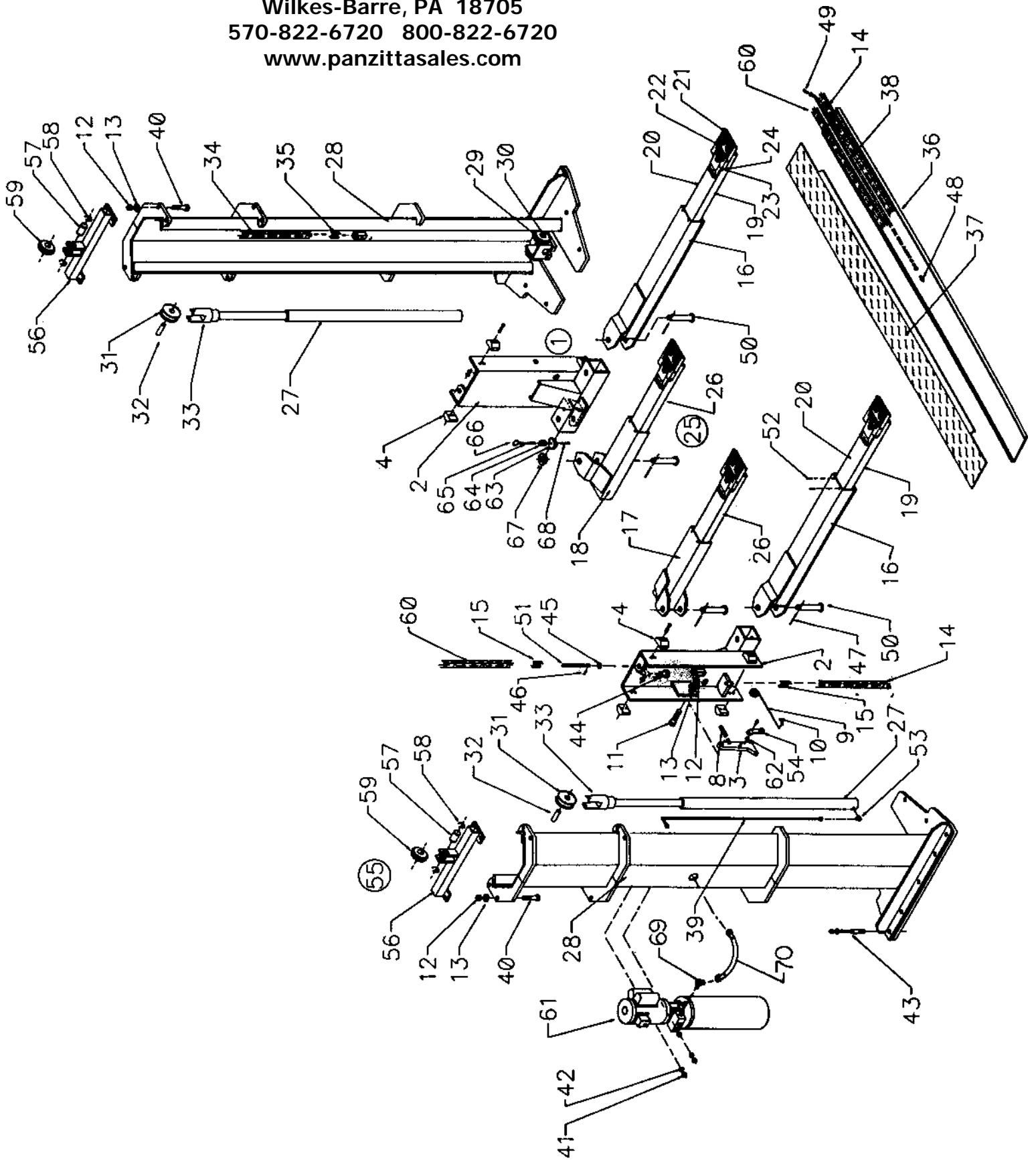

PARTS LIST

ITEM	QTY.	PART NO.	DESCRIPTION	ITEM	QTY.	PART NO.	DESCRIPTION
1	2	1088249	CARRIAGE ASSEMBLY	38	2	1088261	HYDRAULIC LINE CYL-CYL
2	2	1088179	CARRIAGE WELD ASSEMBLY	39	1	1088266	HYDRAULIC LINE CYL-POWER UNIT
3	2	1088238	LOCK PAWL	40	8	S-16329	CAP SCREW 5/8-11 x 2 1/2
4	8	1088750	BEARING BLOCK	41	4	S-16330	LOCKNUT 5/16-18
8	2	1088252	COMPRESSION SPRING	42	4	G-118777	WASHER 5/16
9	2	1088049	RELEASE HANDLE	43	14	1088130	ANCHOR BOLT ASSEMBLY
10	2	S-3627	COTTER PIN	44	2	1088185	CHAIN ADJUSTER
11	2	1088518	CAP SCREW 5/8-11 x 2 3/4 GR.8	45	2	S-498	HEX JAM NUT 5/8-11
12	10	1088126	LOCKNUT 5/8-11	46	2	S-107	COTTER PIN 1/8 x 11/4
13	10	S-21137	WASHER 5/8	47	8	1088301	SPIRAL ROLL PIN
14	2	1088263	EQUALIZING CHAIN-SHORT ANSI 65	48	1	1088098	STRAIGHT CONNECTOR
15	6	1087586	MASTER LINK FOR ANSI 65	49	2	1088282	HYDRAULIC FITTING MALE 45 ELBOW
16	2	1088305	LONG ARM	50	4	1088299	ARM PIVOT PIN
17	1	1088303	SHORT ARM	51	2	1087583	CHAIN ADJUSTER
18	1	1088304	SHORT ARM	52	8	1088256	SPIRAL ROLL PIN
19	2	1088254	EXTENSION ARM ASSEMBLY-LONG	53	2	1088138	ELBOW
20	2	1088222	LONG ARM EXTENSION	54	2	1088663	RELEASE PIVOT
21	4	M-2139	ADAPTER HIGH PAD	55	2	1088259	WHEEL CARRIER ASSEMBLY
22	4	M-2138	ADAPTER LOW PAD	56	2	1088224	WHEEL CARRIER
23	8	S-19977	CLEVIS PIN	57	2	1088568	CHAIN WHEEL SHAFT
24	8	S-19326	ROLL PIN, 1/8 x 5/16	58	4	1088092	RETAINING RING
25	2	1088253	EXTENSION ARM ASSEMBLY-SHORT	59	2	1087637	CHAIN WHEEL ASSEMBLY
26	2	1088221	SHORT ARM EXTENSION	60	2	1088264	EQUALIZING CHAIN-LONG ANSI 65
27	2	1088130	CYLINDER ASSEMBLY	61	1	1088327	POWER UNIT
29	4	1088174	CHAIN ROLLER WHEEL ASSEMBLY	62	2	1087425	SPACER
28	2	1088144	MAST	63	4	1088296	LOCKING GEAR
30	4	1088258	RETAINING RING	64	4	1088297	COMPRESSION SPRING
31	2	1088619	LIFT WHEEL ASSEMBLY	65	4	1088298	LOCKING GEAR SHAFT
32	2	1087223	LIFT WHEEL SHAFT	66	4	1087996	LIFTING RING
33	2	1088950	CHAIN WHEEL MOUNTING BRACKET	67	4	1088300	PIN GEAR
34	2	1088108	LIFT CHAIN	68	4	1088302	ADJUSTING BOLT
35	4	1088104	MASTERLINK W/SIDE PLATES FOR BL-646	69	1	1088283	ELBOW
36	1	1088226	CHAIN TROUGH	70	1	1088284	HOSE
37	1	1088234	CHAIN COVER				

PARTS USED ON AFH-88W

- 1088377 ROLLER-LESS CHAIN 11.25" QTY. 2
- 1088378 CHAIN TROUGH QTY. 1
- 1088379 CHAIN COVER QTY. 1
- 1088380 HYDRAULIC LINE EXTENSION QTY. 1
- 1087586 MASTERLINK QTY. 2
- 1088098 STRAIGHT CONNECTOR QTY. 1

POWER UNIT PARTS LIST

PANZITTA SALES & SERVICE
 72 George Avenue
 Wilkes-Barre, PA 18705
 570-822-6720 800-822-6720
 www.panzittasales.com

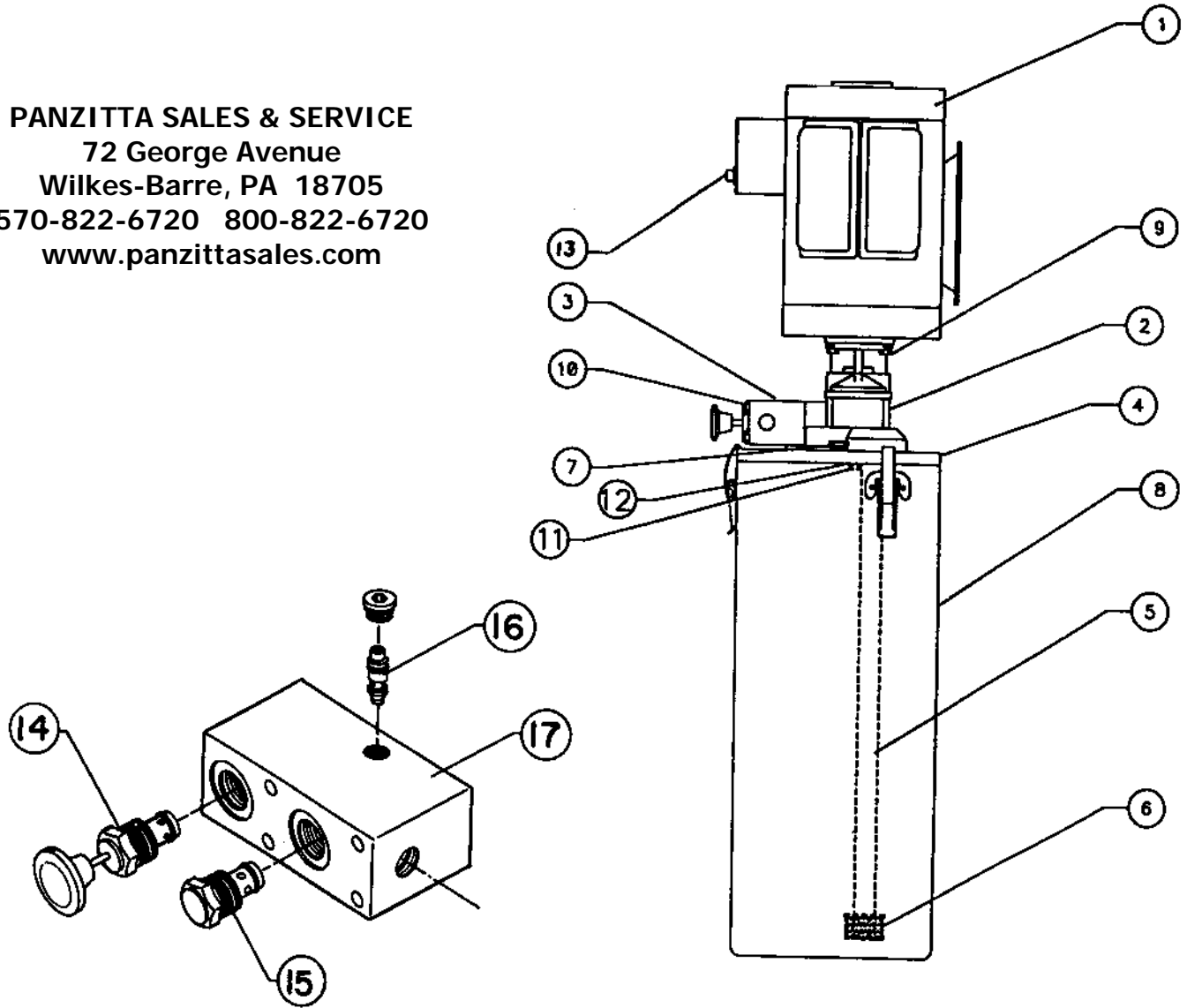

ITEM	PART NO.	QTY.	DESCRIPTION
1	1087539	1	MOTOR
2	1087540	1	PUMP DO7
	1088324	1	PUMP DO5 (AFH-88)
3	1087541	1	VALVE ASSEMBLY
4	1087542	1	MOUNTING PLATE
5	1087547	1	SUCTION LINE
	1088757	1	SUCTION LINE (T22)
6	1087549	1	FILTER
7	1086730	1	BREATHER, 3/8" NPT
8	1088271	1	RESERVOIR ASS'Y
	1088272	1	RESERVOIR ASS'Y (T22)
9	S-7428	4	HEX HD BOLT, 5/16-18 x 3/4
10	1087544	4	HEX HD BOLT, 1/4-20 x 2 3/4
11	S-1204	1	HEX HD BOLT, 5/16-18 x 1
12	S-19957	1	FLATWASHER
13	1088765	1	SWITCH
14	1088465	1	DUMP VALVE
15	1088466	1	CHECK VALVE
16	1088467	1	VENT VALVE
17	1088468	1	VALVE BODY