

# INSTALLATION INSTRUCTIONS AND SERVICE PARTS LIST

# WEAVER<sup>®</sup>

## FOR TWO POST (SURFACE MOUNTED) HYDRAULIC LIFT

These automotive lifts comply with all requirements of the current American ANSI B153.1, as issued by the National Bureau of Standards of the United States Department of Commerce.

**PANZITTA SALES & SERVICE**  
 72 George Avenue  
 Wilkes-Barre, PA 18705  
 570-822-6720 800-822-6720  
 www.panzittasales.com

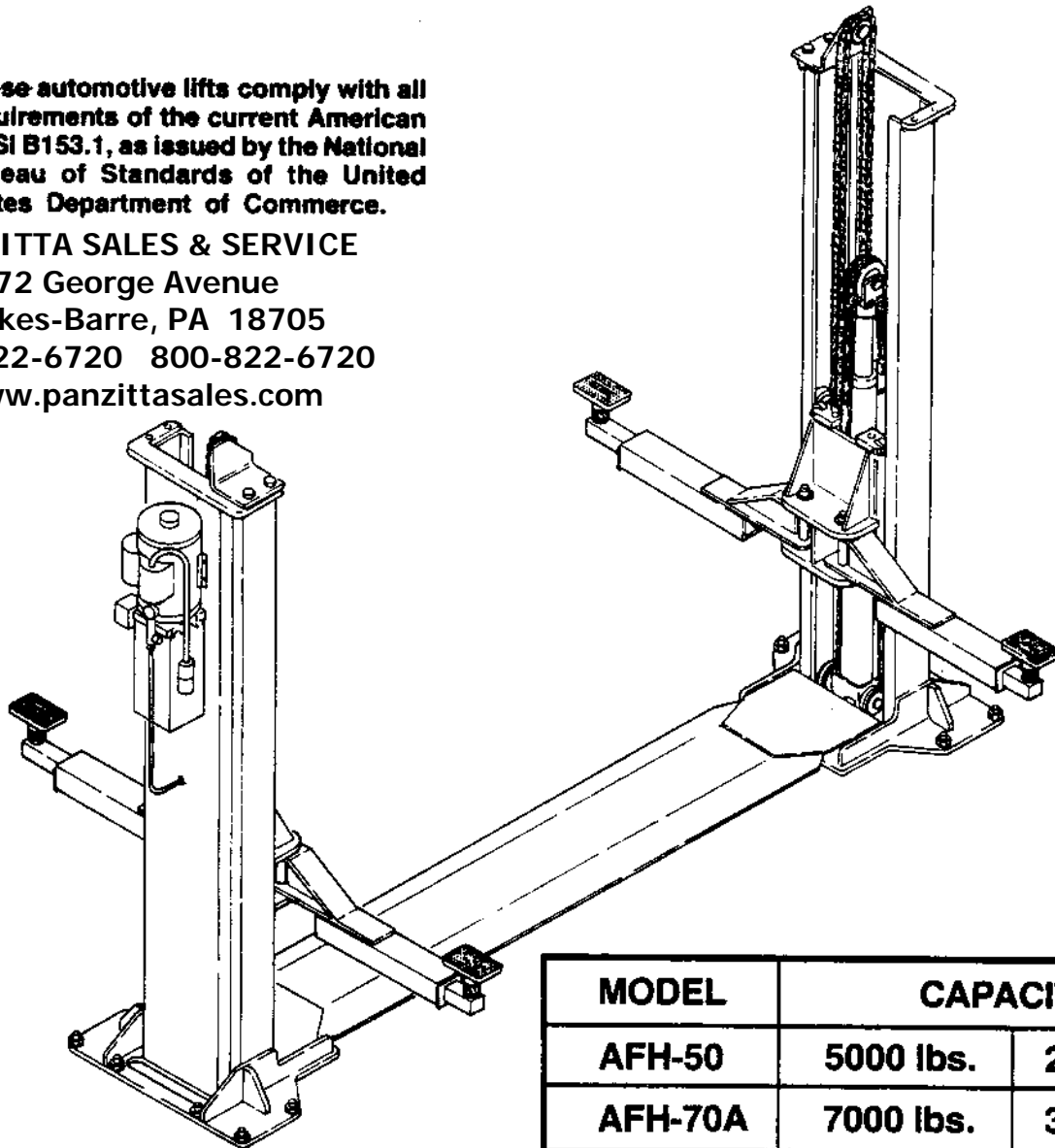

MODEL	CAPACITY	
AFH-50	5000 lbs.	2,268 Kg
AFH-70A	7000 lbs.	3,175 Kg
AFH-90A	9000 lbs.	4,082 Kg

MODEL NO. \_\_\_\_\_

INSTALLER \_\_\_\_\_

SERIAL NO. \_\_\_\_\_

DATE INSTALLED \_\_\_\_\_

**WARNING**

Do not start installation before studying this booklet to become familiar with installation procedure. Acquaint yourself with model type to avoid improper installation.

PANZITTA SALES & SERVICE  
72 George Avenue  
Wilkes-Barre, PA 18705  
570-822-6720 800-822-6720  
www.panzittasales.com

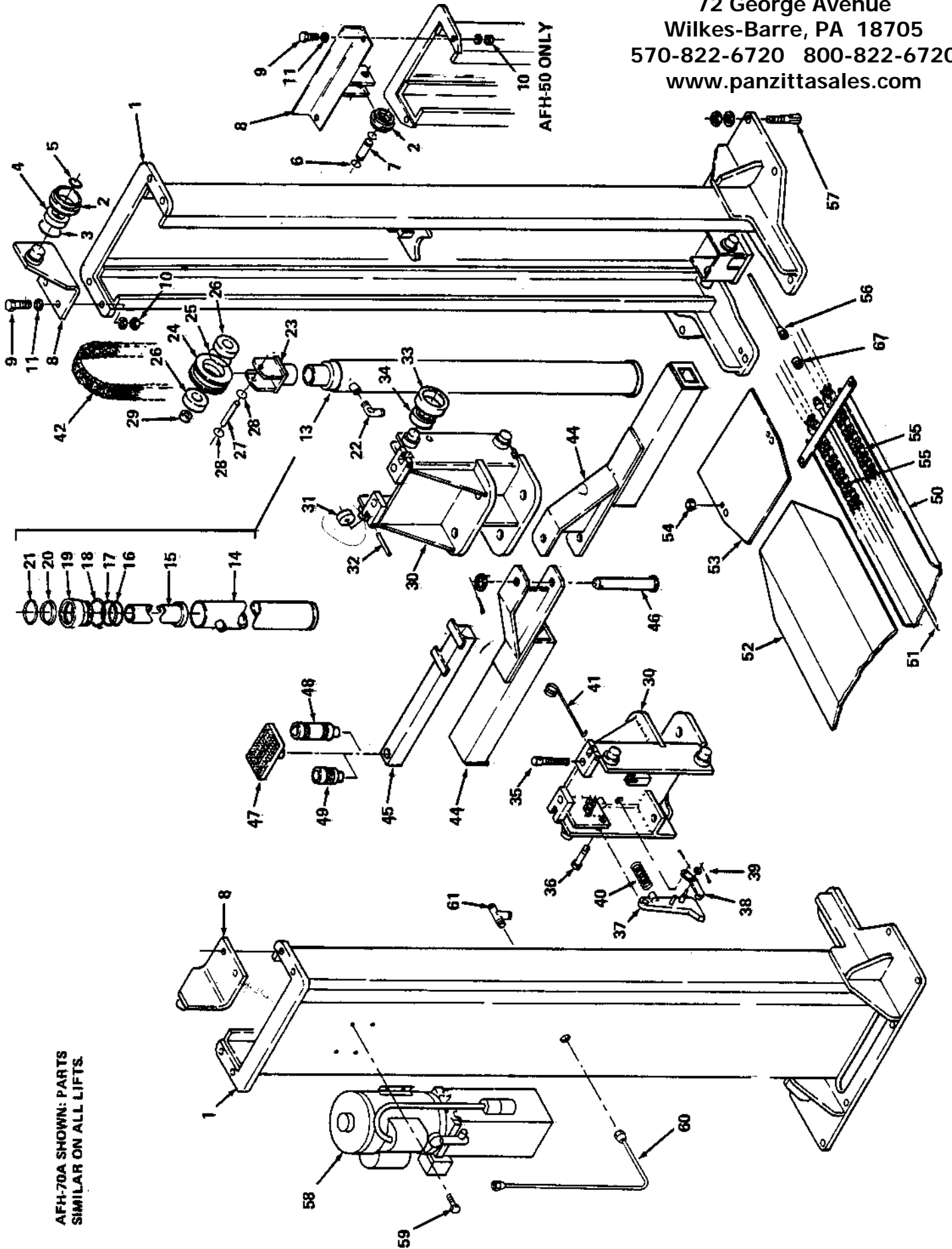

TEM NO.	PART NO.	QUANTITY -50-70A-90A	DESCRIPTION	ITEM NO.	PART NO.	QUANTITY -50-70A-90A	DESCRIPTION
1.	1086650	1 - -	Mast (Power Side) W.A.	37.	1086661	2 - -	Lift Latch Pawl W.A.
	1086637	1 - -	Mast (Non Power Side) W.A.		1086515	- 2 2	Lift Latch Pawl W.A.
	1086558	- 2 -	Mast W.A.	38.	1086663	2 2 2	Release Pivot
	1086559	- - 2	Mast W.A.	39.	S-21850	2 2 2	Washer
2.	1086677	3 - -	Guide Wheel		S-275	2 2 2	1/8 Cotter
	1086115	- 6 6	Guide Wheel	40.	1086050	2 2 2	Compression Spring
3.	1086149	3 - -	Inner Snap Ring	41.	1086049	2 2 2	Release Handle
	1086092	- 6 6	Inner Snap Ring		S-3627	2 2 2	1/16 x 1/2 Cotter
4.	1085150	3 - -	Bearing	42.	1086681	1 - -	Chain (Leaf)
	1086089	- 6 6	Bearing		1086108	- 2 2	Chain (Leaf)
5.	1086090	- 6 6	Outer Snap Ring		1086104	2 4 4	Master Link w/side Plates & Cotter
6.	S-20036	6 - -	E-Type Ring	43.	1086145	2 2 2	Warning Decal (Not Shown)
7.	1086648	3 - -	Guide Wheel Shaft	44.	1086621	4 - -	Arm W.A.
8.	1086674	1 - -	Carriage Stop (Power Side)		1086527	- 4 -	Arm W.A.
	1086647	1 - -	Mast Top W.A.		1086546	- - 4	Arm W.A.
	1086554	- 2 2	Wheel Carrier Bracket W.A.	45.	1086627	4 - -	Extension Arm W.A.
9.	G-181167	4 - -	Bolt 1/2" x 1-1/2"		1086532	- 4 -	Extension Arm W.A.
	S-16329	- 4 4	Bolt 5/8" x 2-1/2"		1086548	- - 4	Extension Arm W.A.
10.	S-12540	4 - -	1/2" Locknut	46.	1086630	4 - -	Pivot Pin W.A.
	1086126	- 4 4	5/8" Locknut		1086530	- 4 -	Pivot Pin W.A.
11.	G-118777	8 - -	Washer 1/2"		1086036	- - 4	Pivot Pin W.A.
	S-21137	- 8 8	Washer 5/8"	47.	1086632	4 - -	Swivel Foot Pad
12.	1086144	1 2 2	Decal (Not Shown)		1086113	- 4 4	Swivel Foot Pad
13.	1086088	- 1 1	Hyd. Cylinder Ass'y	48.	1086635	4 - -	Swivel Foot Adapter
	1086600	1 - -	Hyd. Cylinder Ass'y		1086033	- 4 4	Swivel Foot Adapter
14.	1086172	- 1 1	Cylinder Tube W.A.	49.	1086636	4 - -	Swivel Foot Adapter
	1086603	1 - -	Cylinder Tube W.A.		1086032	- 4 4	Swivel Foot Adapter
15.	1086162	- 1 1	Plunger Ass'y	50.	1086071	- 1 -	Chain Trough
	1086608	1 - -	Plunger Ass'y		1086054	- - 1	Chain Trough
16.	1086166	- 1 1	O-Ring	51.	1086073	- 1 -	Hydraulic Connector Line
	1086611	1 - -	O-Ring		1086057	- - 1	Hydraulic Connector Line
17.	1086167	- 1 1	Back-Up Ring	52.	1086668	1 - -	Chain Cover
	1086613	1 - -	Back-Up Ring		1086072	- 1 -	Chain Cover
18.	1086170	- 1 1	Gland Retaining Wire		1086055	- - 1	Chain Cover
	1086609	1 - -	Gland Retaining Wire	53.	1086056	- 2 2	Base Closing Plate
19.	1086165	- 1 1	Gland	54.	1086131	4 4 4	1/2" Locknut
	1086602	1 - -	Gland	55.	1086671	1 - -	Chain
20.	1086168	- 1 1	U-Cup		1086562	- 2 -	Equalizing Chain
	1086612	1 - -	U-Cup		1086563	- - 2	Equalizing Chain
21.	1086169	- 1 1	Rod Wiper		1086112	2 4 4	Master Link w/side Plates & Cotter
	1086610	1 - -	Rod Wiper	56.	1086022	- 2 2	Cylinder Hyd. Line
22.	1086138	1 1 1	Elbow	57.	1086130	10 16 16	Anchor Bolt Ass'y
23.	1086019	- 1 1	Chain Wheel Mntg. Brkt.	58.	1085242	1 1 1	Motor/Pump/Reservoir
	1086615	1 - -	Chain Wheel Mntg. Brkt.	59.	1086679	4 4 4	Threaded Roll'g Screw 5/16-18
24.	1086020	- 1 1	Wheel	60.	1086023	1 1 1	Hyd. Line
	1086620	1 - -	Wheel	61.	1086140	- 1 1	Tee
25.	1086089	2 2 2	Radial Bearing	62.	1086132	1 1 1	Motor Control Handle
26.	1086092	1 1 1	Inner Ring	63.	1086121	1 1 1	Knob
27.	1086556	- 1 1	Roller Pin	64.	1086122	1 1 1	Clevis Pin
	1086618	1 - -	Roller Pin	65.	1086123	1 1 1	Speed Nut
28.	S-18764	- 2 2	Retaining Ring	66.	1086125	1 1 1	Female Electric Plug
29.	1086021	- 1 1	Wheel Axle & Spacer	67.	1086098	- 2 2	Coupling
30.	1086666	1 - -	Carriage (Power Side) W.A.				
	1086652	1 - -	Carriage (Non Power Side) W.A.				
	1086508	- 2 -	Carriage W.A.				
	1086537	- - 2	Carriage W.A.				
31.	1086095	8 8 8	Cam Roller				
32.	1086096	8 8 8	Roll Pin				
33.	1086675	8 8 8	Carriage Roller				
34.	1086089	8 8 8	Radial Ball Bearings				
35.	1085240	1 2 2	Adjusting Screw				
	1085241	1 2 2	Nylon Insert Locknut 7/8-9				
36.	1086518	2 2 2	5/8"-11 Bolt Grade 8				
	S-21137	2 2 2	Flat Washer				
	G-274821	2 2 2	5/8 Locknut				

NOT SHOWN

**PANZITTA SALES & SERVICE**  
**72 George Avenue**  
**Wilkes-Barre, PA 18705**  
**570-822-6720 800-822-6720**  
**www.panzittasales.com**