

# WEAVER®

## PARTS LIST FOR TWO POST (SURFACE MOUNTED) HYDRAULIC LIFT

These automotive lifts comply with all requirements of the current American ANSI B153.1, as issued by the American National Standards Institute.

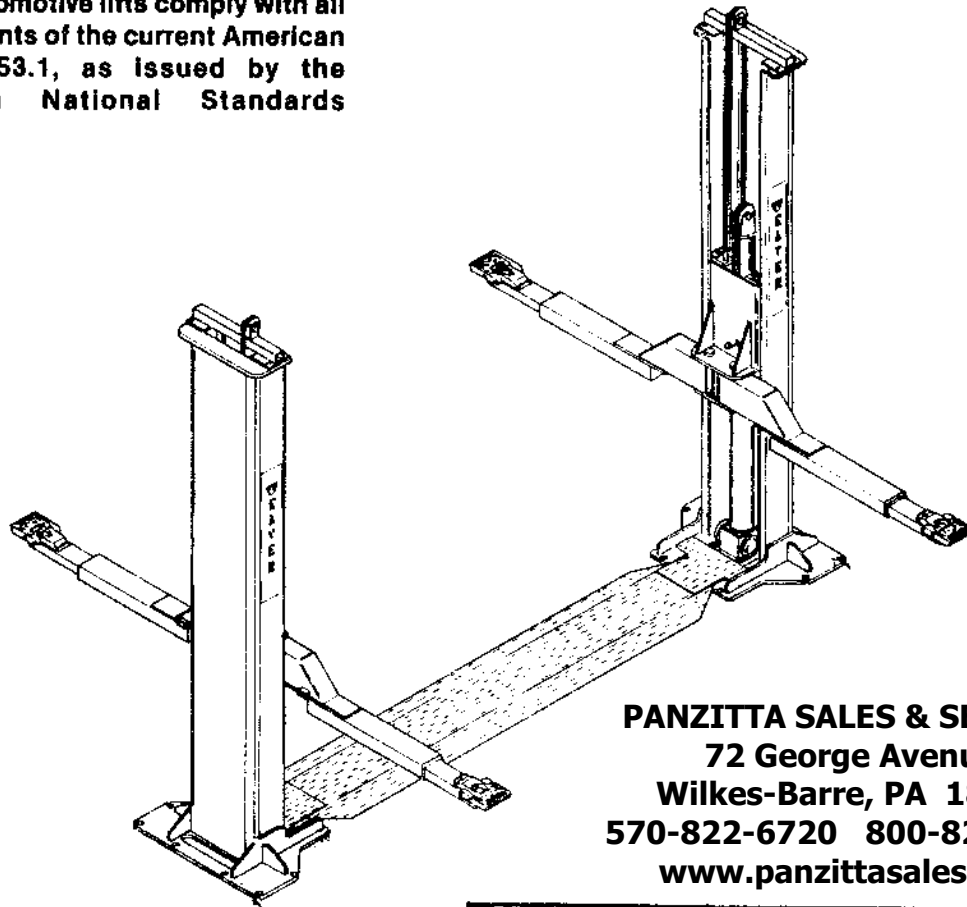

**PANZITTA SALES & SERVICE**  
72 George Avenue  
Wilkes-Barre, PA 18705  
570-822-6720 800-822-6720  
[www.panzittasales.com](http://www.panzittasales.com)

(AFH-90B SHOWN)

MODEL	CAPACITY	
AFH-50A	5000 lbs.	2,268 Kg
AFH-70B	7000 lbs.	3,175 Kg
AFH-90B	9000 lbs.	4,082 Kg

MODEL NO. \_\_\_\_\_ INSTALLER \_\_\_\_\_

SERIAL NO. \_\_\_\_\_

DATE INSTALLED \_\_\_\_\_

**WARNING**  
Do not start installation before studying this booklet to become familiar with installation procedure. Acquaint yourself with model type to avoid improper installation.

**PANZITTA SALES & SERVICE**  
72 George Avenue  
Wilkes-Barre, PA 18705  
570-822-6720 800-822-6720  
[www.panzittasales.com](http://www.panzittasales.com)

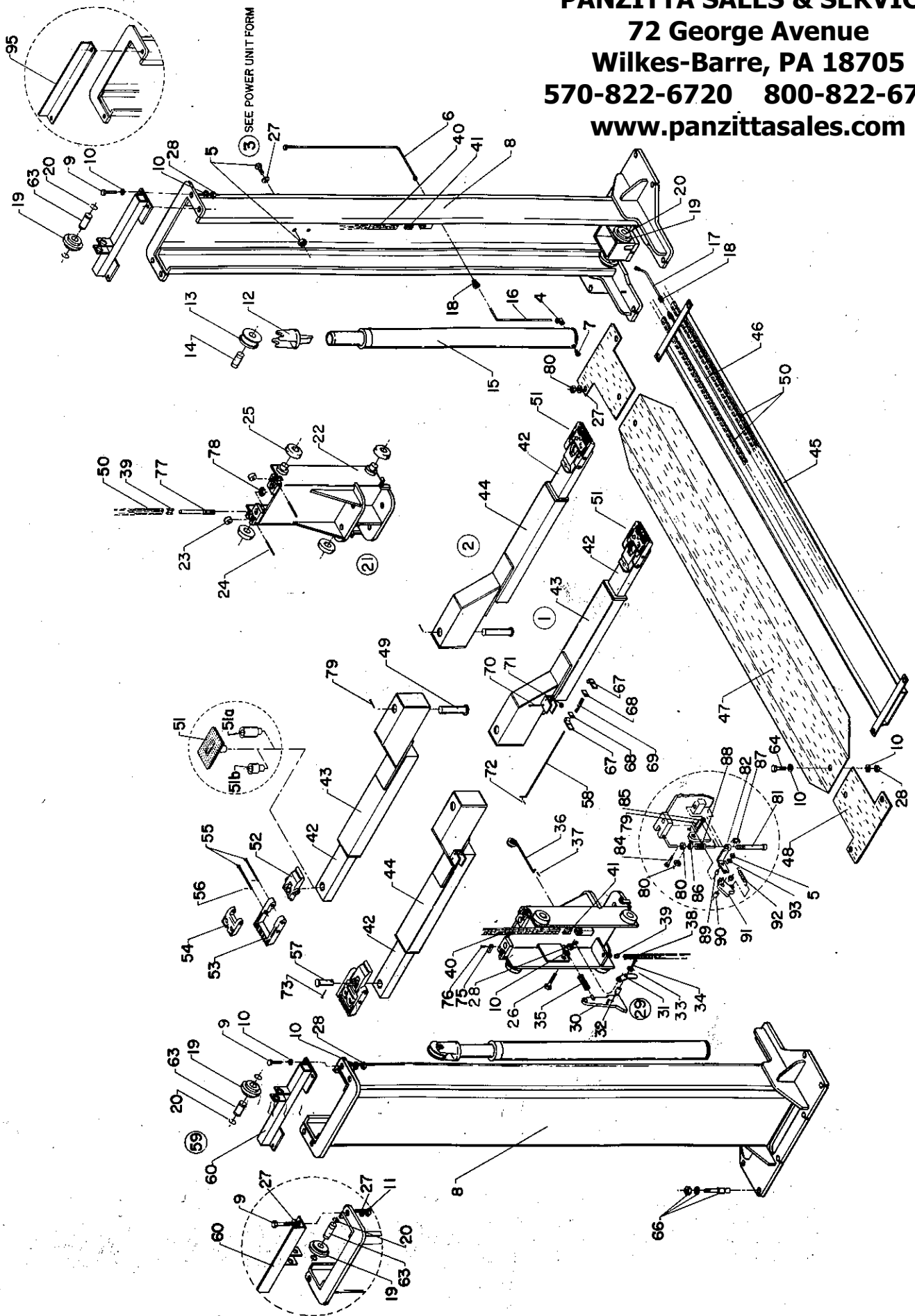

# PARTS LIST

#	PART NO.	QUANTITY						DESCRIPTION	#	PART NO.	QUANTITY						DESCRIPTION
		50	50FM	70B	70BFM	90B	90BFM				50	50FM	70B	70BFM	90B	90BFM	
1.	1087404	-	-	-	-	2	2	ARM ASS'Y, RIGHT (INCLUDES 43.51,57,73)	42.	1086532	-	-	4	4	-	-	EXTENTION ARM W.A.
2.	1087405	-	-	-	-	2	2	ARM ASS'Y, LEFT, (INCLUDES 44.51,57,73)		1086587	4	4	-	-	-	-	EXTENTION ARM W.A.
3.	SEE FORM	1	1	1	1	1	1	POWER UNIT (ORDER BY CYCLE AND PHASE)	43.	1085982	-	-	-	-	2	2	ARM W.A. RIGHT SIDE (INCL. EXT. ARM, ITEM 42)
4.	1086138	2	2	2	2	2	2	COMPRESSION ELBOW		1085996	2	2	-	-	-	-	ARM W.A. RIGHT ARM
5.	1086695	4	4	4	4	4	4	LOCKNUT, 5/16"-18		1086373	-	-	2	2	-	-	ARM W.A. RIGHT ARM
	S-7428	4	4	4	4	4	4	HEX HD BOLT, 5/16"-18 x 3/4"	44.	1085983	-	-	-	-	2	2	ARM W.A. LEFT SIDE (INCL. EXT. ARM, ITEM 42)
6.	1087303	1	1	1	1	1	1	HYD. LINE, POWER UNIT		1085997	2	2	-	-	-	-	ARM W.A. LEFT ARM
7.	1086136	-	-	2	2	2	2	HYD. STRAIT FITTING		1086372	-	-	2	2	-	-	ARM W.A. LEFT ARM
8.	1086558	-	-	2	-	-	-	MAST W.A.	45.	1086071	-	-	1	-	-	-	CHAIN TROUGH
	1087191	-	-	-	2	-	-	MAST W.A.		1086445	-	-	-	1	-	-	CHAIN TROUGH
	1086559	-	-	-	-	2	-	MAST W.A.		1086054	-	-	-	-	1	-	CHAIN TROUGH
	1087192	-	-	-	-	-	2	MAST W.A.		1086709	-	1	-	-	-	-	CHAIN TROUGH
	1086650	1	-	-	-	-	-	MAST W.A. (POWER)		1086428	-	-	-	-	-	1	CHAIN TROUGH
	1086537	1	-	-	-	-	-	MAST W.A. (SLAVE)	46.	1086073	-	-	1	-	-	-	HYD. LINE BETWEEN CYL.
	1086387	-	1	-	-	-	-	MAST W.A. (POWER)		1086057	-	-	-	-	1	-	HYD. LINE BETWEEN CYL.
	1086398	-	1	-	-	-	-	MAST W.A. (SLAVE)		1087446	-	-	1	-	-	1	HYD. LINE
9.	S-16329	-	-	8	8	8	8	HEX HD. BOLT, 5/8"-11 x 2 1/2" GD2		1087447	-	-	-	-	-	-	HYD. LINE
	G-181167	4	4	-	-	-	-	HEX HD. BOLT, 1/2"-13 x 1 1/4" GD5		1087445	-	-	1	-	-	-	HYD. LINE
10.	S-21137	-	-	22	22	22	22	WASHER, 5/8"	47.	1086072	-	-	1	-	-	-	CHAIN TROUGH COVER
11.	S-12540	4	4	-	-	-	-	LOCKNUT, 1/2"-13		1086568	1	-	-	-	-	-	CHAIN TROUGH COVER
12.	1086950	1	1	2	2	2	2	LIFT WHEEL YOKE — CASTING — USE WITH HOLLOW PISTON ROD		1087333	-	-	-	1	-	-	CHAIN TROUGH COVER
										1086055	-	-	-	1	-	-	CHAIN TROUGH COVER
13.	1086619	1	1	2	2	2	2	LIFT WHEEL ASS'Y		1087332	-	-	-	-	-	1	CHAIN TROUGH COVER
14.	1087223	1	1	2	2	2	2	LIFT WHEEL SHAFT — USE WITH CAST YOKE		1086710	-	1	-	-	-	-	CHAIN TROUGH COVER
15.	1087415	-	-	2	2	2	2	HYD. CYL. ASS'Y (HYD. FITTING AT BOTTOM)	48.	1086056	-	-	2	-	2	-	BASE CLOSING PLATE
	1085951	-	-	-	-	-	-	HYD. RAM ASS'Y (HYD. FITTING AT TOP) QLD STYLE AFH-70/90		1087226	-	-	-	2	-	2	BASE CLOSING PLATE
	KL-284	-	-	-	-	-	-	GLAND AND SEAL REPACKING KIT FOR 1085951	49.	1086530	-	-	4	4	-	-	PIVOT PIN
	KL-293	-	-	-	-	-	-	SEAL REPACKING KIT FOR 1085951		1086630	4	4	-	-	-	-	PIVOT PIN
	1087505	1	1	-	-	-	-	HYD. RAM ASS'Y		1086036	-	-	-	-	4	4	PIVOT PIN
	KL-312	-	-	-	-	-	-	CONVERTS OLD 1086600 CYL. TO NEW 1087505, AFH-50	50.	1086582	-	-	2	2	-	-	EQUALIZING CHAIN ROLLERLESS 255"
16.	1087302	-	-	1	1	1	1	HYD. LINE CYLINDER		1086713	1	1	-	-	-	-	EQUALIZING CHAIN ROLLERLESS 89"
	1087470	1	1	-	-	-	-	HYD. LINE CYLINDER		1086583	-	-	-	-	2	2	EQUALIZING CHAIN ROLLERLESS 191"
17.	1087414	-	-	2	2	2	2	HYD. LINE	51.	1086326	-	-	-	-	4	4	EQUALIZING CHAIN ROLLERLESS 285"
18.	1086098	1	1	3	4	3	4	HYD. COUPLING		1085831	4	4	4	4	-	-	SWIVEL ADAPTOR ASS'Y (INCLUDES 52-58)
19.	1086302	-	2	6	6	6	6	CHAIN GUIDE WHEEL	51a.	1086635	2	2	2	2	-	-	SWIVEL FOOT PAD (STEEL)
	1086677	3	1	-	-	-	-	CHAIN GUIDE WHEEL	51b.	1086636	4	4	4	4	-	-	SWIVEL FOOT PAD (LONG)
20.	1086092	-	4	8	8	8	8	RETAINING RING, 1 3/8" EXT.	52.	M-2140	-	-	-	-	4	4	ADAPTER BASE
	1087394	6	2	-	-	-	-	RETAINING RING, 1" E TYPE	53.	M-2139	-	-	-	-	4	4	ADAPTER HIGH PAD
21.	1085802	-	-	2	2	-	-	CARRIAGE ASS'Y (INCLUDES, 22-41,75-76)	54.	M-2138	-	-	-	-	4	4	ADAPTER LOW PAD
	1085986	-	-	-	2	2	2	CARRIAGE ASS'Y (INCLUDES, 22-41,75-76)	55.	S-19977	-	-	-	-	8	8	CLEVIS PIN
	1086330	1	1	-	-	-	-	CARRIAGE ASS'Y POWER (INCLUDES, 22-41,50,75-76,79-94)	56.	S-19326	-	-	-	-	8	8	ROLL PIN, 1/8" x 5/16"
	1086532	1	1	-	-	-	-	CARRIAGE ASS'Y SLAVE (INCLUDES, 22-39,50,75-76)	57.	1086325	-	-	-	-	4	4	SWIVEL PIN
22.	1086508	-	-	2	2	-	-	CARRIAGE WELD	58.	1086371	4	4	4	4	-	-	ARM LOCK ROD
	1087213	1	1	-	-	-	-	CARRIAGE WELD POWER	59.	1085981	-	-	-	-	4	4	ARM LOCK ROD
	1086389	1	1	-	-	-	-	CARRIAGE WELD SLAVE	60.	1086566	-	-	2	2	2	2	WHEEL CARRIER ASS'Y (INCLUDES 60,19,20,63)
	1085985	-	-	-	2	2	2	CARRIAGE WELD		1086647	1	1	-	-	-	-	WHEEL CARRIER BRKT.
23.	1086095	8	8	8	8	8	8	CAM ROLLER	63.	1086668	-	-	2	2	2	2	GUIDE WHEEL SHAFT
24.	1086096	-	-	8	8	8	8	ROLL PIN 7/16" x 2 1/4"		1086546	3	3	-	-	-	-	GUIDE WHEEL SHAFT
	1086565	8	8	-	-	-	-	ROLL PIN 7/16" x 4"	64.	S-1203	-	-	-	-	2	2	HEX HD. BOLT, 5/8"-11 x 1 1/4" GD2
25.	1086665	8	8	8	8	8	8	CARRIAGE ROLLER ASS'Y	66.	1086130	10	10	16	16	16	16	ANCHOR BOLT ASS'Y
26.	1086518	2	2	2	2	2	2	HEX HD. BOLT, 5/8"-11 x 2 1/4" GD8	67.	1085990	8	8	8	8	8	8	SQUEEZE PLATE
27.	G-118777	16	16	8	8	8	8	WASHER, 1/2"	68.	1085980	8	8	8	8	8	8	LOCK PLATE
28.	G-274821	2	2	12	12	12	12	LOCKNUT, 5/8"-11	69.	1085989	4	4	4	4	4	4	COMPRESSION SPRING
29.	1086517	-	-	2	2	2	2	LIFT LOCK ASS'Y (INCLUDES, 30-34)	70.	1085991	8	8	8	8	8	8	MACHINE SCREW, #10-24 x 1 1/4"
	1086660	1	1	-	-	-	-	LIFT LOCK ASS'Y (INCLUDES, 30-34)	71.	1085992	8	8	8	8	8	8	LOCKNUT, #10-24
30.	1086515	-	-	2	2	2	2	LIFT LOCK PAWL W.A.	72.	S-14760	4	4	4	4	4	4	ROLL PIN, 1/8" x 1/4"
	1086661	2	2	-	-	-	-	LIFT LOCK PAWL W.A.	73.	S-25511	-	-	-	-	4	4	ROLL PIN, 3/8" x 2 1/4"
31.	1086663	2	2	2	2	2	2	RELEASE PIVOT	75.	1087331	8	8	8	8	8	8	TOP ROLLER GUARD
32.	1087424	-	-	2	2	2	2	SPACER	76.	1087330	16	16	16	16	16	16	DRIVE SCREW
	1087425	2	2	-	-	-	-	SPACER	77.	1085240	1	1	2	2	2	2	ADJUSTING SCREW, 7/8"-9
33.	1087427	2	2	2	2	2	2	THRUST BEARING	78.	1085241	1	1	2	2	2	2	NYLON LOCKNUT, 7/8"-9
34.	1087422	-	-	2	2	2	2	SHOULDER BOLT	79.	S-18074	5	5	4	4	4	4	ROLL PIN, 1/4" x 1 5/8"
	1087423	2	2	-	-	-	-	SHOULDER BOLT	80.	1086131	7	7	4	4	4	4	LOCKNUT, JAM 1/2"-13
35.	1086050	2	2	2	2	2	2	COMPRESSION SPRING	81.	1086688	1	1	-	-	-	-	PIN
36.	1086049	2	2	2	2	2	2	RELEASE HANDLE	82.	1086693	1	1	-	-	-	-	BRACKET ARM
37.	S-3627	2	2	2	2	2	2	COTTER PIN, 1/16" x 1/2"	84.	S-3629	1	1	-	-	-	-	HEX BOLT, 5/16"-18 x 1 1/4" GD2
38.	1086148	-	-	2	2	2	2	EQUALIZING CHAIN, ROLLERLESS 35"	85.	1086700	1	1	-	-	-	-	HEX BOLT, 1/2"-13 x 2" GD5
39.	1086112	3	3	6	6	6	6	MASTER LINK W/PLATE AND COTTER PINS FOR EQUALIZING CHAIN	87.	1086898	1	1	-	-	-	-	SPRING SPACER
40.	1086108	-	-	2	2	2	2	LIFT CHAIN, LEAF 56 1/4"	88.	1086702	1	1	-	-	-	-	SPRING COMP.
	1086681	1	1	-	-	-	-	LIFT CHAIN, LEAF 44 1/4"	89.	1086690	1	1	-	-	-	-	BUSHING
41.	1086104	2	2	4	4	4	4	MASTER LINK W/PLATES AND COTTER PINS FOR LEAF CHAIN	90.	1086889	1	1	-	-	-	-	PAWL BUSHING
									91.	1086699	1	1	-	-	-	-	PAWL
									92.	1083893	1	1	-	-	-	-	SPRING EXT.
									93.	S-19957	1	1	-	-	-	-	WASHER, 5/16"
									95.	1086648	1	1	-	-	-	-	CARRIAGE STOP (POWER SIDE)

**PANZITTA SALES & SERVICE**

**72 George Avenue**

**Wilkes-Barre, PA 18705**

**570-822-6720 800-822-6720**

**www.panzittasales.com**