

PANZITTA SALES & SERVICE  
72 George Avenue  
Wilkes-Barre, PA 18705  
570-822-6720 800-822-6720  
www.panzittasales.com

**WALKER**

**SERVICE  
DIVISION**

## Jack Parts Sheet

**MODEL 93731  
SERIES "E & F"**

**20 TON CAPACITY**

AIR-HYDRAULIC SERVICE JACK

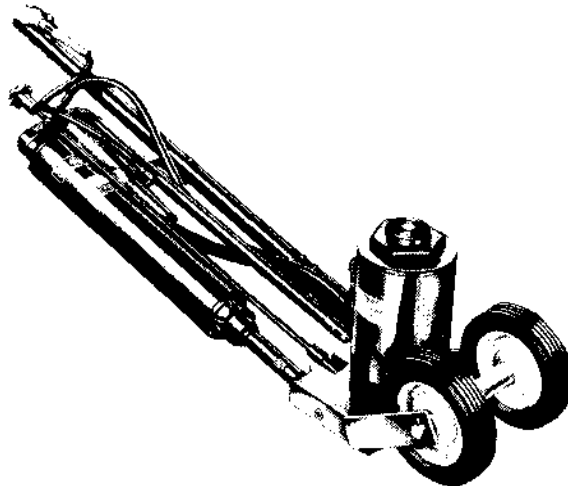

**MODEL 93731  
SERIES "E & F"**

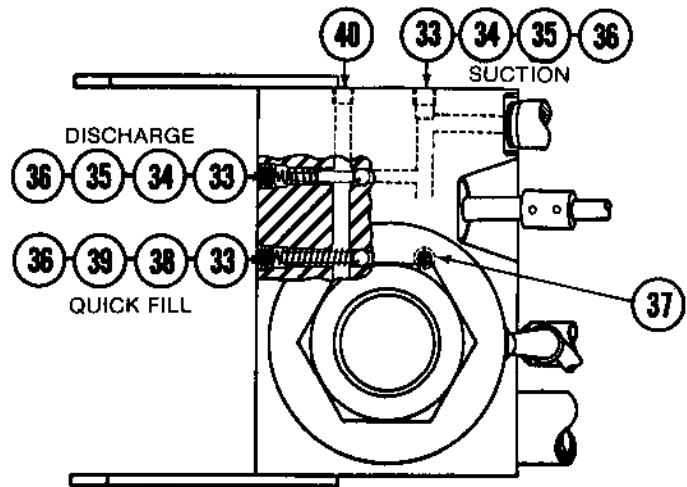
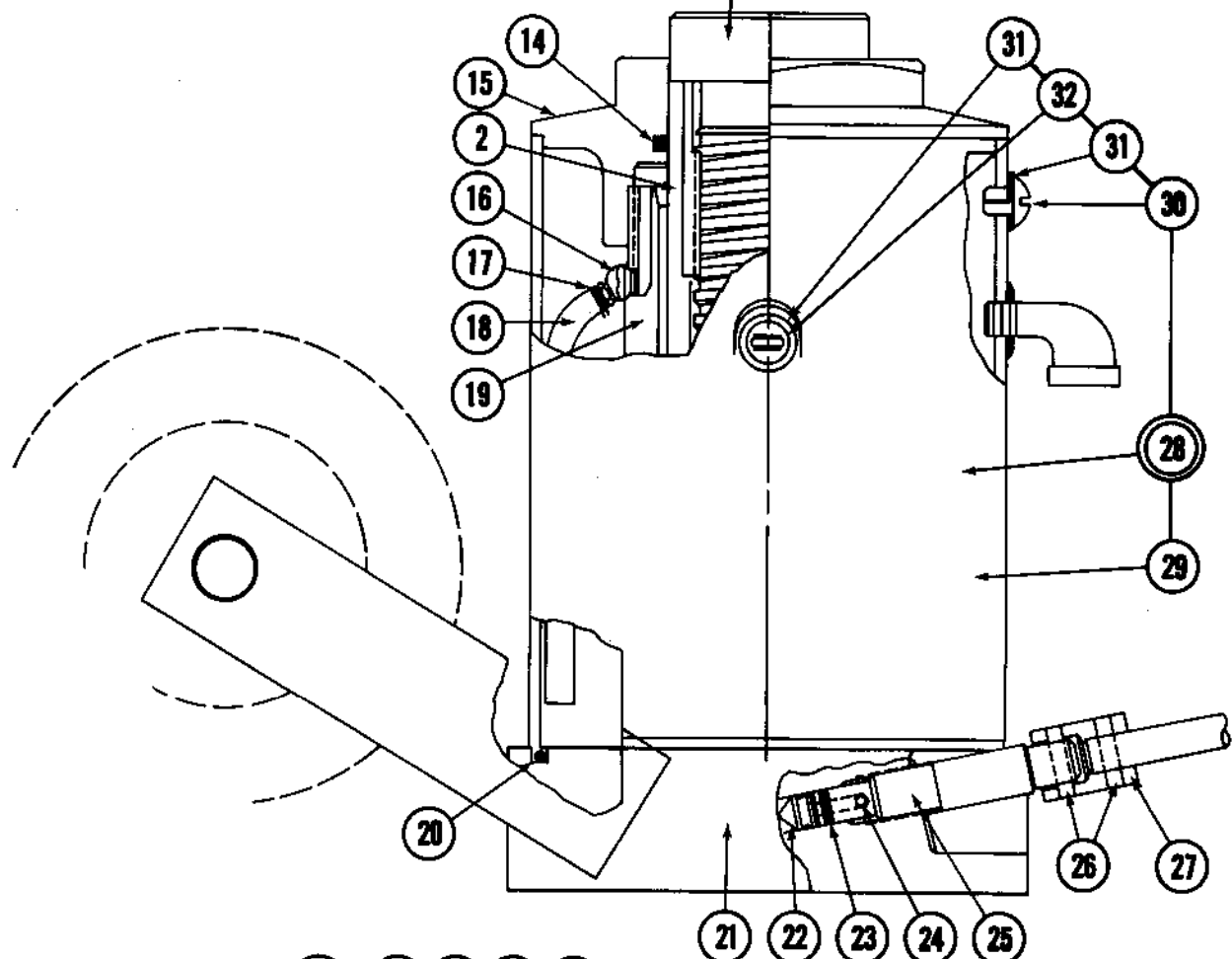
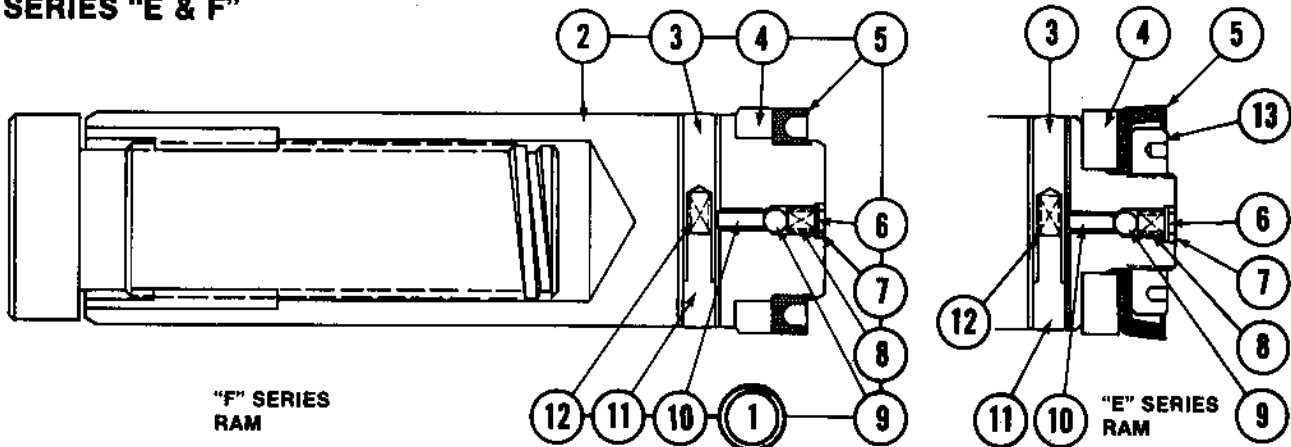

**BASE ASSY. - TOP VIEW**

**ORDER BY PART NUMBER,  
NOT BY CODE NUMBER  
SEE BACK PAGE FOR  
COMPLETE NUMERICAL LISTING**

**PANZITTA SALES & SERVICE**  
**72 George Avenue**  
**Wilkes-Barre, PA 18705**  
**570-822-6720 800-822-6720**  
**www.panzittasales.com**

CODE NO.	PART NO.		DESCRIPTION	QUANTITY
	SERIES "E"	SERIES "F"		
1	227531	230134	Ram Assembly - Complete	1
2	228098	230731	Ram, Extension Screw & Cap Assy.	1
3	228090	228090	Cross Pin - Female	1
4	226383	230125	Heel Plate	1
5	214904	230126	"U" Cup	1
6	223166	223166	Screen	1
7	210411	210411	Washer	1
8	226331	226331	Spring	1
9	203199	203199	Ball Valve	1
10	225483	225483	Pin	1
11	228091	228091	Cross Pin - Male	1
12	216647	216647	Valve Spring	1
13	226382	None	Nut - Ram Cup	1
14	224648	224648	"O" Ring	1
15	227136	227136	Tank Nut	1
16	224120	224120	Snorkel Fitting	1
17	221059	221059	Hose Clamp	1
18	227534	227534	Snorkel Tube	1
19	227533	227533	Cylinder - Ram	1
20	228099	228099	"O" Ring	1
21	228309	228309	Base Assembly	1
22	224061	224061	Valve	1
23	214555	214555	"O" Ring	1
24	203196	203196	Ball	1
25	224060	224060	Stem Release	1
26	217649	217649	Roll Pin	2
27	224164	224164	Adapter - Release Rod	1
28	228321	228321	Tank - Assembly	1
29	228310	228310	Tank	1
30	224073	224073	Vent Screw	1
31	200003	200003	Gasket	2
32	212540	212540	Filler Screw	1
33	203202	203202	Ball - Discharge/Suction	3
34	224180	224180	Spacer	2
35	226401	226401	Spring	2
36	229131	229131	Pipe Plug	3
37	222533	222533	Screen	1
38	224053	224053	Spring	1
39	228234	228234	Spacer	1
40	210311	210311	Pipe Plug	1

**MODEL 93731  
SERIES "E & F"**

INLET -  
CLEAN AIR FROM  
WATER SEPARATOR

**226456 AIR HYDRAULIC PUMP**

**(41)**

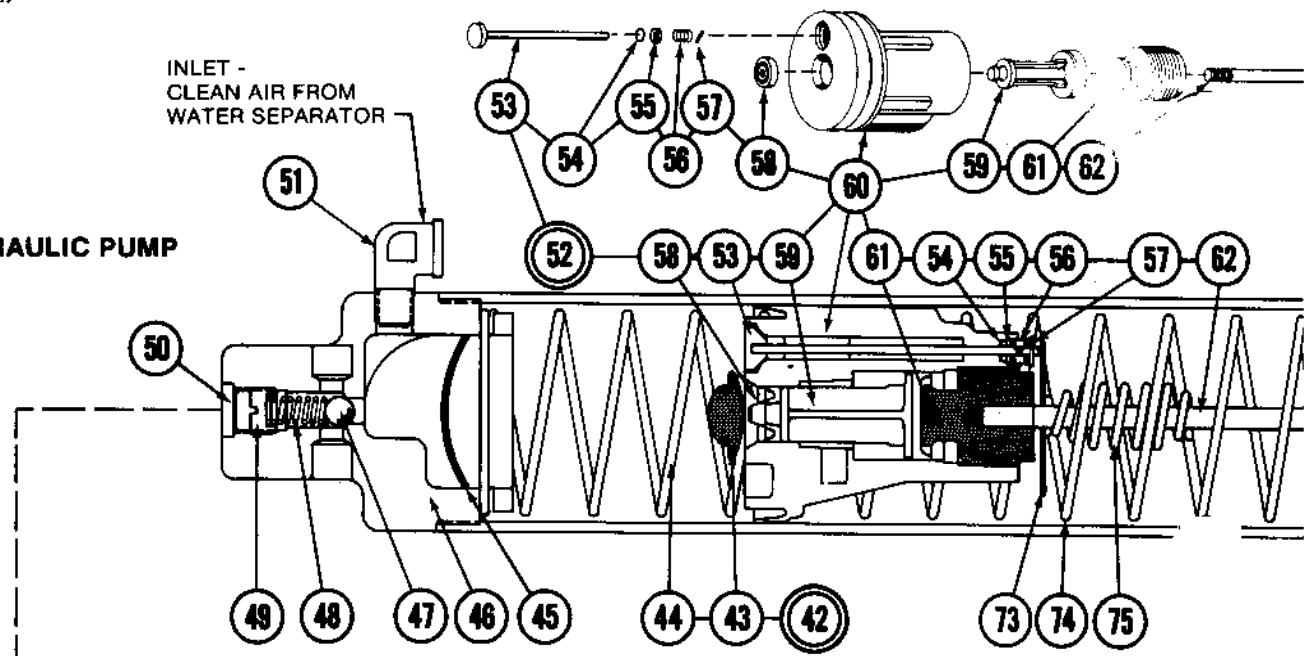

**SPEED PACK SUPPORT**

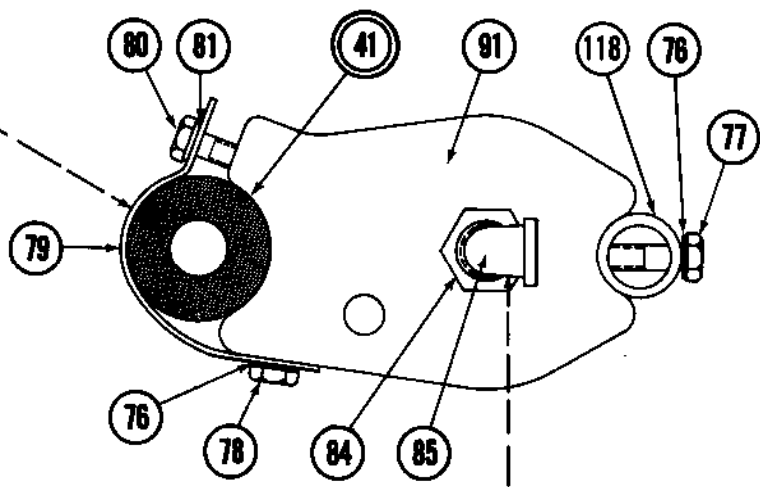

**WATER SEPARATOR &  
DIFFERENTIAL VALVE ASSEMBLY**

**(82)**

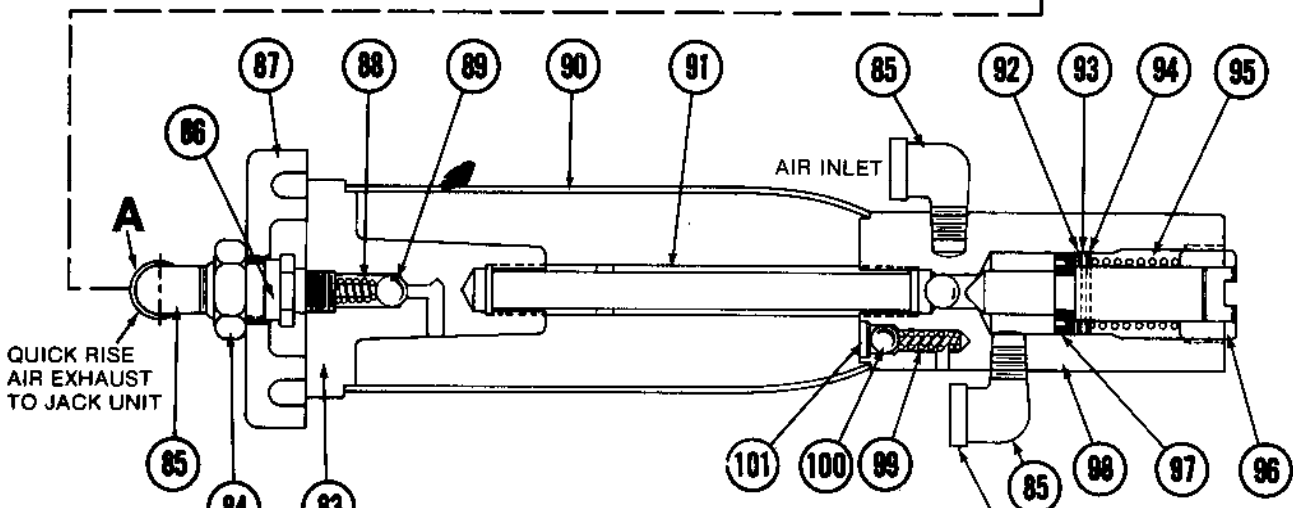

Note - Adjust (Code #96) pressure packing nut so differential valve opens at 60 P.S.I. when opening "A" is plugged and Air Pressure is applied to air inlet.

CLEAN AIR TO  
AIR-HYD. PUMP

ORDER BY PART NUMBER, **NOT** BY CODE NUMBER  
SEE BACK PAGE FOR COMPLETE NUMERICAL LISTING

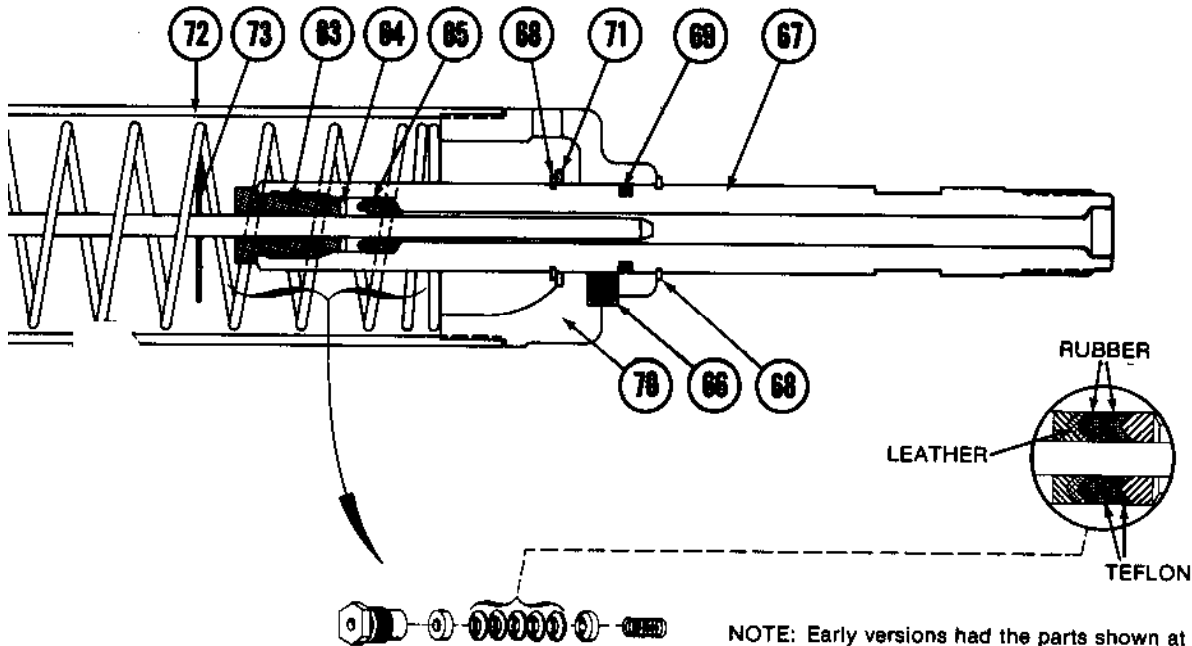

NOTE: Early versions had the parts shown at left.  
If repairs are required in this area, discard  
all parts pictured and replace with  
Code Nos. 63, 64 & 65.

CODE NO.	PART NO.	DESCRIPTION	QUANTITY	CODE NO.	PART NO.	DESCRIPTION	QUANTITY
41	228929	Air - Hydraulic Pump	1	71	224469	Washer	1
42	223194	Spring & Cushion Assy.	1	72	224034	Cylinder	1
43	225371	Cushion	1	73	223203	Trip Washer	2
44	226153	Spring	1	74	223173	Spring Return	1
45	223880	Screen	1	75	225384	Trip Spring	1
46	224155	Cylinder Cap	1	76	201787	Lock Washer	2
47	203202	Ball Valve	1	77	224643	Bolt	1
48	224156	Spring	1	78	212586	Bolt	1
49	226373	Adjusting Screw	1	79	224639	Clamp	1
50	201733	Plug	1	80	224642	Bolt	1
51	222202	Elbow	1	81	224343	Washer	1
52	228930	Piston Assy.	1	82	224157	Water Separator	1
53	223187	Valve Plunger	1	83	226956	End Block	1
54	222288	"O" Ring	1	84	203299	Nut	1
55	228813	Washer	1	85	222202	Elbow	3
56	223184	Spring	1	86	224187	Adapter	1
57	228235	Cotter Pin	1	87	224587	Mounting Block	1
58	221013	"U" Cup	1	88	224074	Spring	1
59	223678	Piston Assy.	1	89	203199	Ball Valve	1
60	228935	Piston/Roll Pin Assy.	1	90	223910	Tank	1
61	223183	Plug Retainer	1	91	224188	Center Tube	1
62	224038	Pump Rod	1	92	224212	Valve	1
63	228814	Gland Nut	1	93	221276	Roll Pin	1
64	228816	Washer	1	94	224213	Washer	2
65	228815	"U" Cup	1	95	224160	Spring	1
66	226451	Set Screw	2	96	222209	Packing Nut	1
67	228933	Cylinder	1	97	216523	"U" Cup	1
68	221820	Retaining Ring	2	98	224210	Differential Valve Block	1
69	219861	"O" Ring	1	99	224163	Spring	1
70	226450	End Block	1	100	203200	Ball Valve	1
				101	221880	Retaining Ring	1

**MODEL 93731  
SERIES "E & F"**

**PANZITTA SALES & SERVICE**  
72 George Avenue  
Wilkes-Barre, PA 18705  
570-822-6720 800-822-6720  
www.panzittasales.com

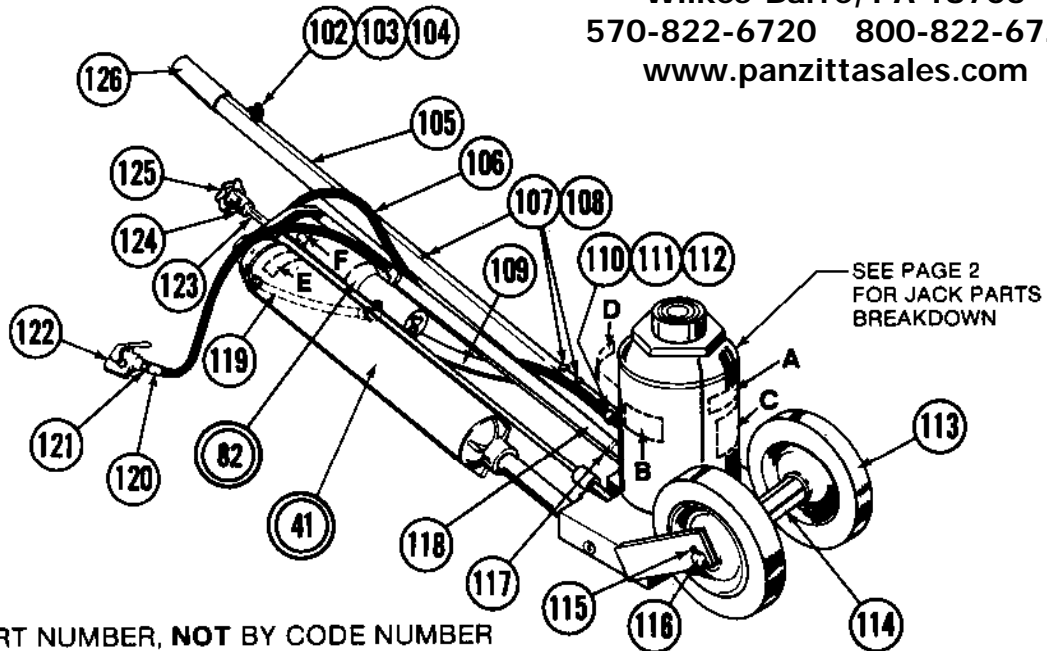

SEE PAGE 2  
FOR JACK PARTS  
BREAKDOWN

ORDER BY PART NUMBER, **NOT** BY CODE NUMBER  
SEE BACK PAGE FOR COMPLETE NUMERICAL LISTING

CODE NO.	PART NO.	DESCRIPTION	QUANTITY
102	223172	Hose Clip	1
103	224081	Screw	1
104	211737	Lockwasher	1
105	224521	Handle	1
106	224183	Air Hose Assembly	1
107	224644	Bolt	3
108	226019	Locknut	3
109	224640	Balance Strap	1
110	223179	Hose Clip	1
111	201787	Lockwasher	1
112	212566	Bolt	1
113	224475	Wheel	2
114	224472	Spacer	1
115	204446	Cotter Pin	2
116	226212	Axle	1
117	217898	Roll Pin	1
118	224638	Support-Power Pac	1
119	224154	Air Hose Assy.	1
120	224182	Air Hose Assy.	1
121	226483	Nipple	1
122	223180	Air Valve	1
123	224165	Rod-Release	1
124	217898	Roll Pin	1
125	224166	Knob	1
126	224641	Handle Grip	1

**Label Locations and Part Numbers**

**A**  224823

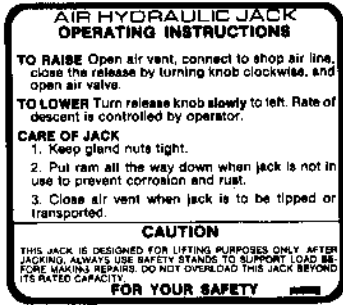
**B**  224930

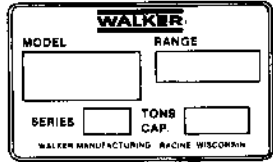
**C**  230148

**D**  212171

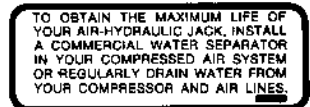
**E**  225639

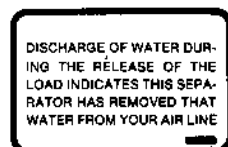
**F**  225638

## NUMERICAL LISTING OF PARTS

Part No.	Code No.	Part No.	Code No.	Part No.	Code No.	Part No.	Code No.
200003	31	223183	61	224469	71	228099	20
201733	50	223184	56	224472	114	228234	39
201787	76, 111	223187	53	224475	113	228235	57
203196	24	223194	42	224521	105	228309	21
203199	9, 89	223203	73	224587	87	228310	29
203200	100	223678	59	224638	118	228321	28
203202	33, 47	223680	45	224639	79	228813	55
203299	84	223910	90	224640	109	228814	63
204446	115	224034	72	224641	126	228815	65
210311	40	224038	62	224642	80	228816	64
210411	7	224053	38	224643	77	228929	41
211737	104	224060	25	224644	107	228930	52
212540	32	224061	22	224648	14	228933	67
212566	78, 112	224073	30	225371	43	228935	60
214555	23	224074	88	225384	75	229131	36
214904	5	224081	103	225483	10	230125	4
216523	97	224120	16	226019	108	230126	5
216647	12	224154	119	226153	44	230134	1
217649	26	224155	46	226212	116	230731	2
217898	117, 124	224156	48	226331	8		
219861	69	224157	82	226373	49		
221013	58	224160	95	226382	13		
221059	17	224163	99	226383	4		
221276	93	224164	27	226401	35		
221820	68	224165	123	226450	70		
221880	101	224166	125	226451	66		
222202	51, 85	224180	34	226483	121		
222209	96	224182	120	226956	83		
222288	54	224183	106	227136	15		
222533	37	224186	91	227531	1		
223166	6	224187	86	227533	19		
223172	102	224210	98	227534	18		
223173	74	224212	92	228090	3		
223179	110	224213	94	228091	11		
223180	122	224343	81	228098	2		