

COATS

1001 & 1001SC

Computer Wheel Balancer

PANZITTA SALES & SERVICE
72 George Avenue
Wilkes-Barre, PA 18705
570-822-6720 800-822-6720
www.panzittasales.com



Parts Identification

READ these instructions before placing unit in service KEEP these and other materials delivered with the unit in a binder near the machine for ease of reference by supervisors and operators.

HENNESSY INDUSTRIES, INC.

P.O. Box 3002, 1601 J. P. Hennessy Drive, LaVergne, TN USA 37086 615/641-7533 800/688-6359

HENNESSY INDUSTRIES INC. Manufacturer of AMMCO®, COATS® and BADA® Automotive Service Equipment and Tools.

Manual Part No.: 8144112

Revision: 01/01 rev. 0

Direct Drive

1001 – 1001SC Parts Identification

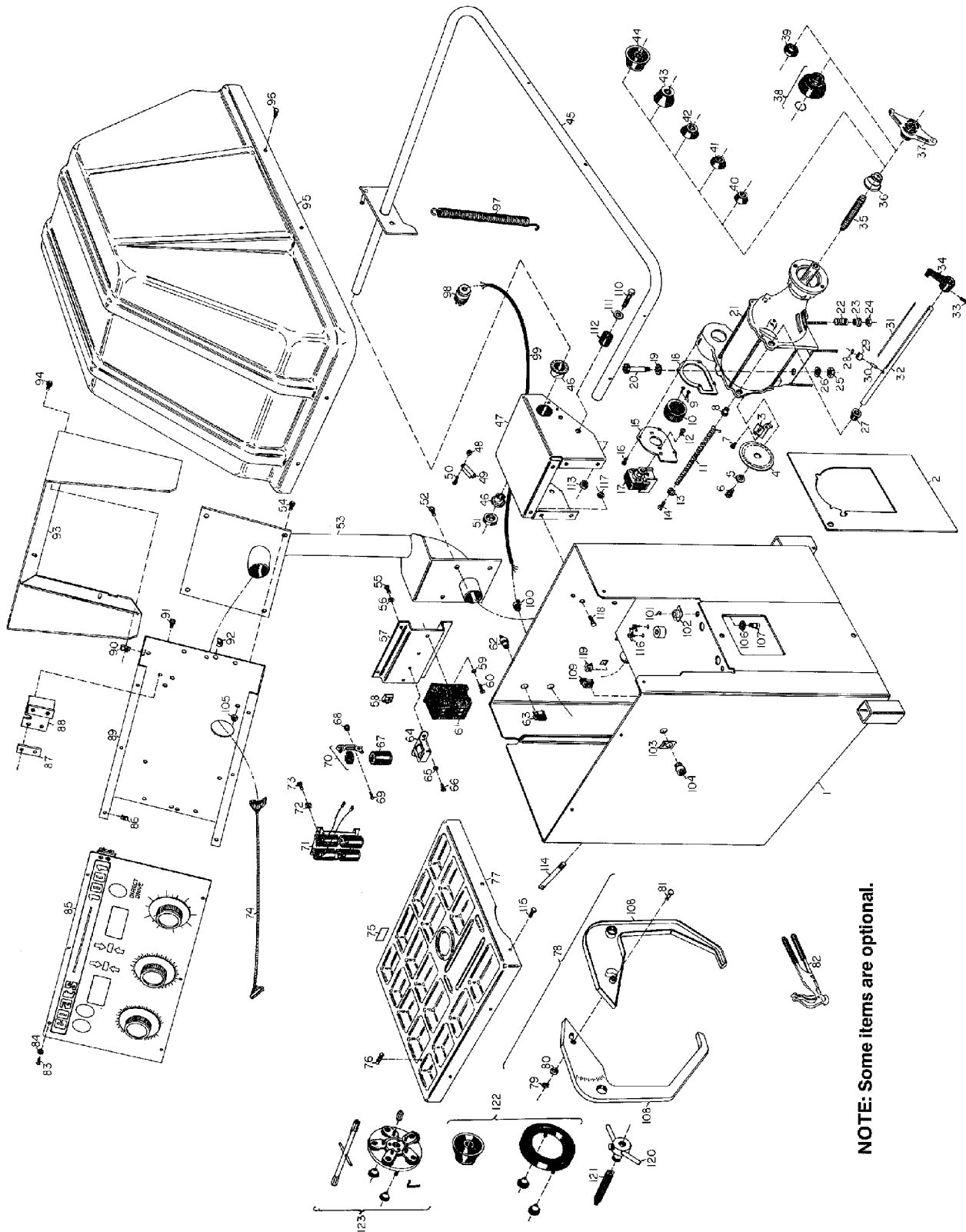

NOTE: Some items are optional.

ITEM	PART NO.	DESCRIPTION	ITEM	PART NO.	DESCRIPTION	ITEM	PART NO.	DESCRIPTION
	8309001	Chassis 1001	46	8307014	Bearing, Flanged	88	8143161	Heat Sink
	8309051	Chassis 1001 SC	47	8309053	Hood Brkt W/C	89	8143160	Pod Control
2	8308032	Motor Gasket	48	8301066	#6 Kep Nut	90	8106304	1/4" Tinnerman Clip
3	8309002	Optical Encoder 1001 REG	49	8305050	Magnetic Switch - Hood	91	8106301	1/4" Self Tap Bolt
	8143211	Optical Encoder 1001 SC	50	8301063	#6 x 1/2" P.H.M.S.	92	8106304	1/4" Tinnerman Clip
4	8308003	Rotary Shutter 1001 REG	51	8309014	Stop Ring Assy.	93	8143159	Pod Cover
	8160001	Rotary Shutter 1001 SC	52	8000524	3/8 x 1 H.H.C.S.	94	8143168	1/4" Whiz Lock Screw
5	8301032	Washer 3/8 Flat	53	8309013	Pod Support W/C	95	8308060	Hood Molded
6	8301016	3/8 x 3/8 x 5/16-18 Shoulder Bolt	54	8143168	1/4" Whiz Lock Screw	96	8106301	1/4" Self Tap Bolt
		Bolt	55	8301082	#8 x 1/2 P.H.M.S.	97	8308062	Spring Hood
7	8301100	#10 x 1/2" P.H.M.S.	56	8301083	#8 Internal Lock Washer	98	8305058	Power Plug 110 V Single Phase
8	8308074	Bushing Rear - Distance Gauge	51	8308021	Power Panel		8305016	Power Plug 220 V Single Phase
9	8309009	Cooling Fan	58	8303116	Bridge Rectifier (110, 1 Phase)		8140786	Power Plug 220 V Three Phase
10	8308023	Spring - Distance Gauge	59	8301083	#8 Internal Lock Washer		8143091	Power Plug 440 V Three Phase
12	8301100	#10 x 1/2 P.H.M.S.	60	8301062	#8 x 1/2 P.H.M.S.	99	8309094	Power Harness (3 Phase & 220V Single phase)
13	8301141	1/4 Flat Washer	61	8305006	Contractor		8309095	Power Harness (110 V Single Phase)
14	8106301	1/4 Self Tapping Bolt	62	8305003	Switch On/Off	100	8150128	Clamp Connecting Cable
19	8301121	1/2 Flat Washer	63	8305080	Off-On (Contact Block)	101	8301017	Ball .500 Dia
20	8301015	1/2 x 2 x 3/8-16 Shoulder Bolt	64	8306806	Transformer 1001 REG	102	8309006	Piezo Sense Assembly
21	8309047	Motor 1 Phase		8150771	Transformer 1001 SC	103	8305092	Start Cover Plate
	8309026	Motor 3 Phase	65	8301083	#8 Internal Lock Washer	104	8305090	Start Botton
22	8307008	Spring Piezo	66	8301082	#8 x 1/2 P.H.M.S.	105	8143169	1/4" Whiz Lock Nut
23	8308036	Retainer Lower - Spring	67	8303194	Capacitor 110 V. Single Phase	106	8301032	3/8 Flat Washer
24	8301033	3/8-16 Hex Nut	68	8301084	#8 Kep Nut	107	8301016	Shoulder Bolt 3/8 x 3/8 x 5/16-18
25	8301035	3/6.16 Hex Nyloc	69	8301093	#8 x 3/4 Flat Head Screw			
26	8301032	3/8 Flat Washer	70	8190131	Capacitor Cap & Brkt. 1 Phase			
27	8308077	Bushing Front - Distance Gauge	71	8143075	Capacitor (4 Pack) 220 Volt Single Phase			
28	8301151	Retainer Ring - Distance Gauge				108	8308103	Caliper Wheel
29	8308075	Roller - Distance Gauge	72	8301083	#8 Internal Lock Washer	109	8305080	Off-On (Contact Block) SC Only
30	8301150	Pin Drive Lock - Grooved	73	8301082	#8 x 1/2 P.H.M.S.	110	8301120	1/2 x 2 1/4 Hez Head Bolt
31	8308079	Scale - Distance Gauge	74	8309096	Signal Harness 1001 REG	111	8301121	1/2" Flat Washer
32	8308078	Shaft - Distance Gauge				112	8309008	Hood Stop
33	8301152	Roll Pin - Distance Gauge	75	8143233	Signal Harness 1001 SC	113	8301122	1/2" Nyloc Nut
34	8308073	Arm - Distance Gauge	76	8314005	Caution Decal	114	8308026	Accessory Pegs
35	8308171	Stub Shaft Coarse Thread	77	8308018	Decal, Weight Tray	115	8106301	Self Tap Bolt
36	8308101	Spring - Back Cone	78	8309011	Weight Tray			
37	8309091	Assembly, Hub Nut Coarse Thread	79	8301153	Caliper Assy	8301091	8301091	#8 x 7/8" Thread Forming Screw
			80	8301032	Retaining Ring	8301154	8301154	Flat Washer
38	8309079	Small Hub Assembly	81	8308090	3/8 Flat Washer	8309049	8309049	Sensistor Ass'y
39	8308105	No Mar Ring	82	8106357	Pin Calipers	8106303	8106303	3/8 Whiz Lock Nut
40	8308069	Cone Miniature	83	8301073	Weight Pliers	8106302	8106302	3/6 Whiz Lock Screw
41	8308096	Cone Small	84	8301061	Circuit Board Screw	8143044	8143044	3/8-16 Tinnerman Nut
42	8308097	Cone Medium	85	8309092	#6 Black Nylon Washer	8308140	8308140	Hub Nut Speed Lock
43	8308098	Cone Large	86	8309108	Front Panel PCB 1001 REG	8308141	8308141	Stub Shaft, Speed Lock
44	8305095	Adapter Large		8309108	Front Panel PCB 1001 SC	8309067	8309067	Large Truck Cone Kit
45	8309012	HoodBar W/C	87	8190034	#6 Tinnerman Clip	8309060	8309060	Combi Adaptor Kit
				8143182	Retainer Heal Sink			

PANZITTA SALES & SERVICE
72 George Avenue
Wilkes-Barre, PA 18705
570-822-6720 800-822-6720
www.panzittasales.com