

**PANZITTA SALES & SERVICE**  
72 George Avenue  
Wilkes-Barre, PA 18705  
570-822-6720 800-822-6720  
[www.panzittasales.com](http://www.panzittasales.com)

**BEN PEARSON**

**PARTS MANUAL -**

**12000-4 MR POST LIFT**  
**12000-4 S/N MR LIFT**

12000 4 MR SN MR MANUAL RELEASE.max

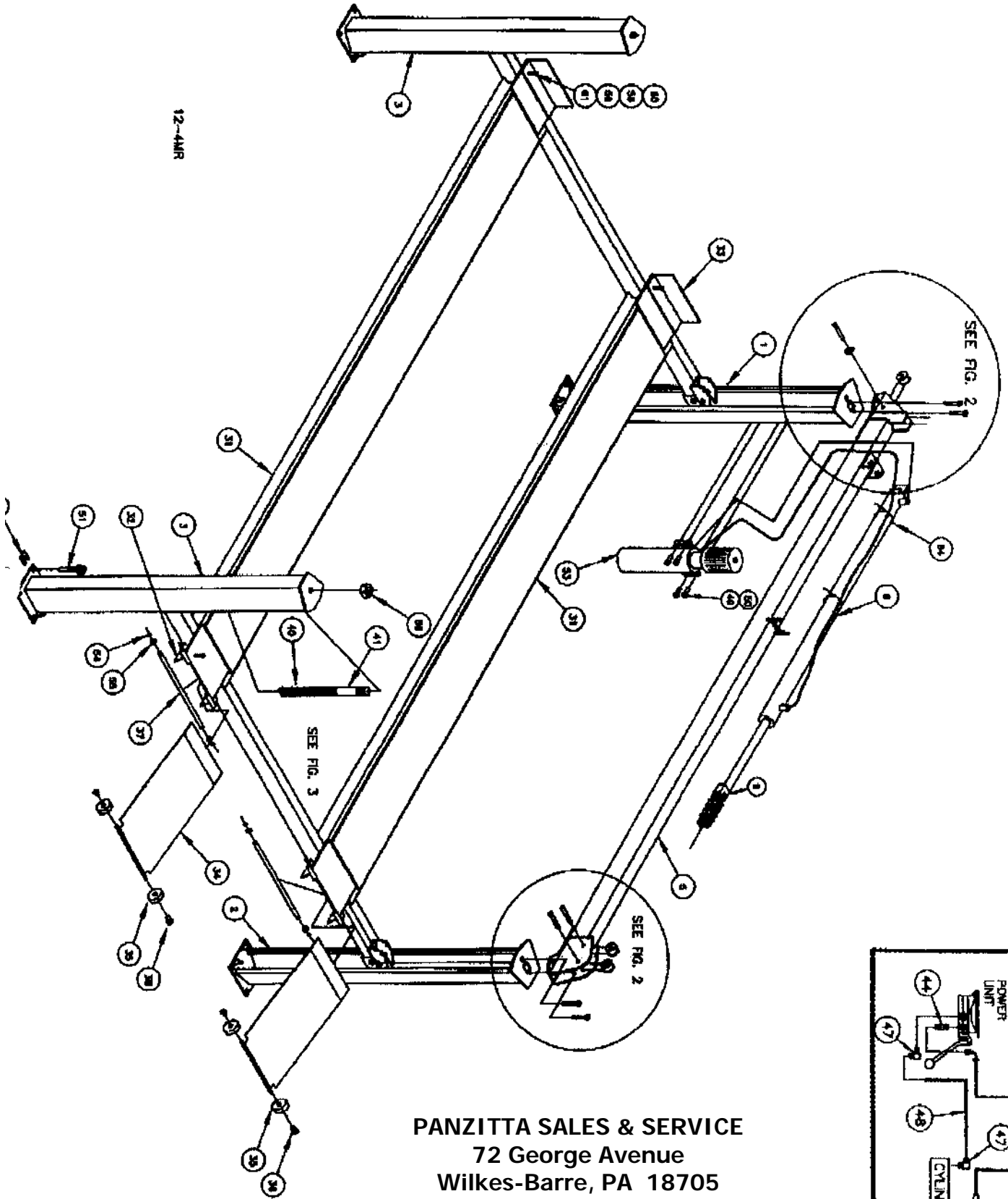
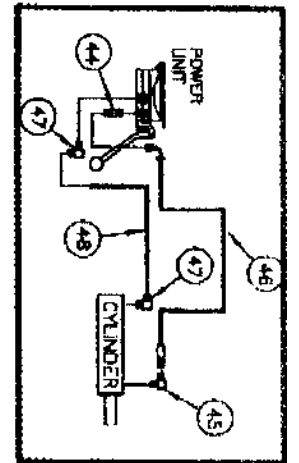
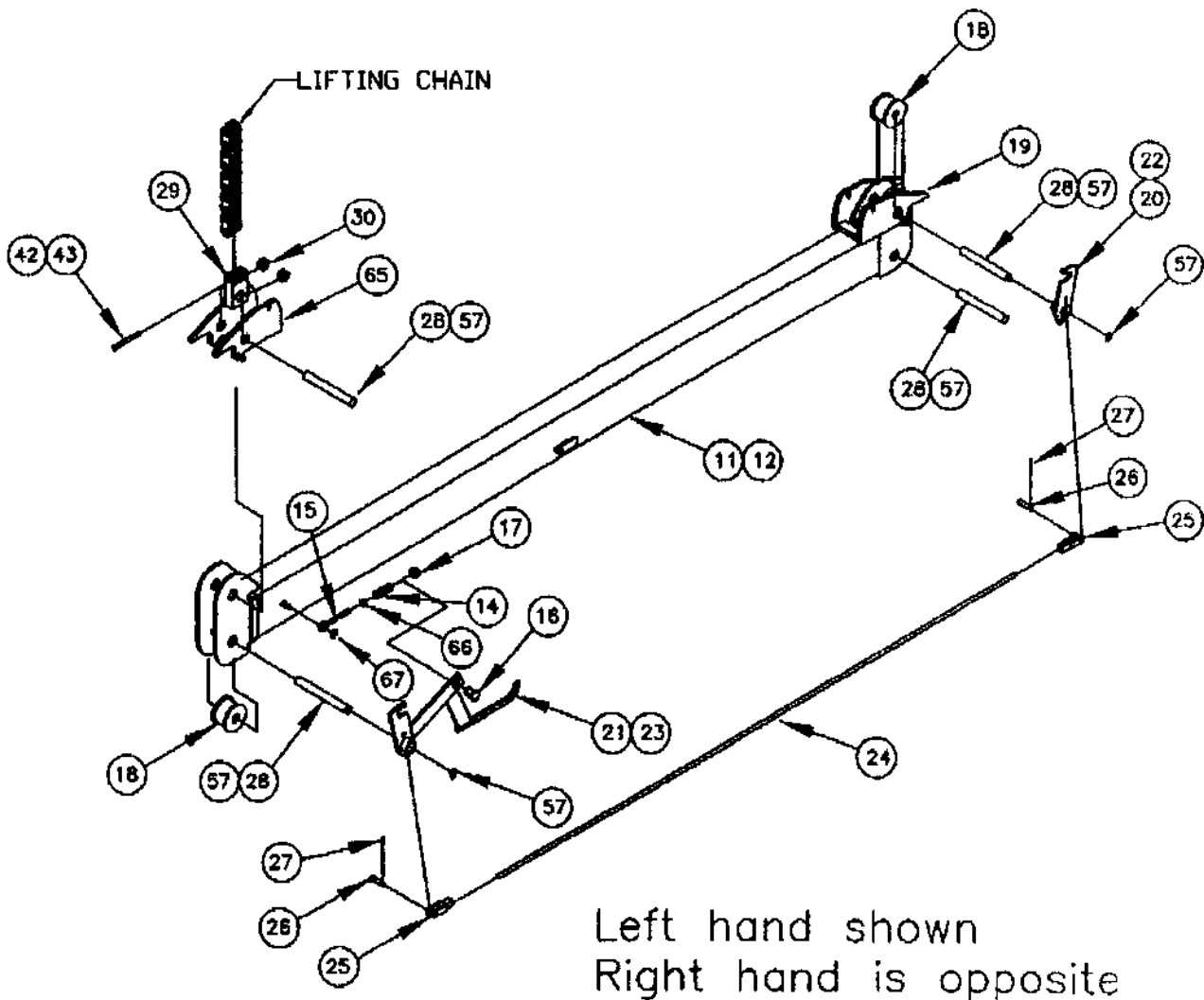

FIG. 1



PANZITTA SALES & SERVICE  
 72 George Avenue  
 Wilkes-Barre, PA 18705  
 570-822-6720 800-822-6720  
 www.panzittasales.com

PANZITTA SALES & SERVICE  
72 George Avenue  
Wilkes-Barre, PA 18705  
570-822-6720 800-822-6720  
www.panzittasales.com



12000 4 MR SN MR MANUAL RELEASE.max

FIG. 2

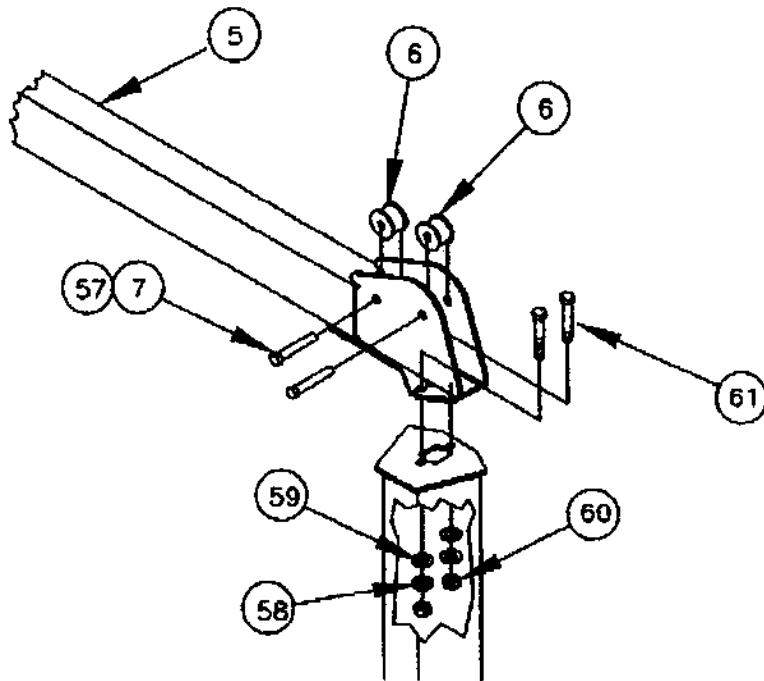
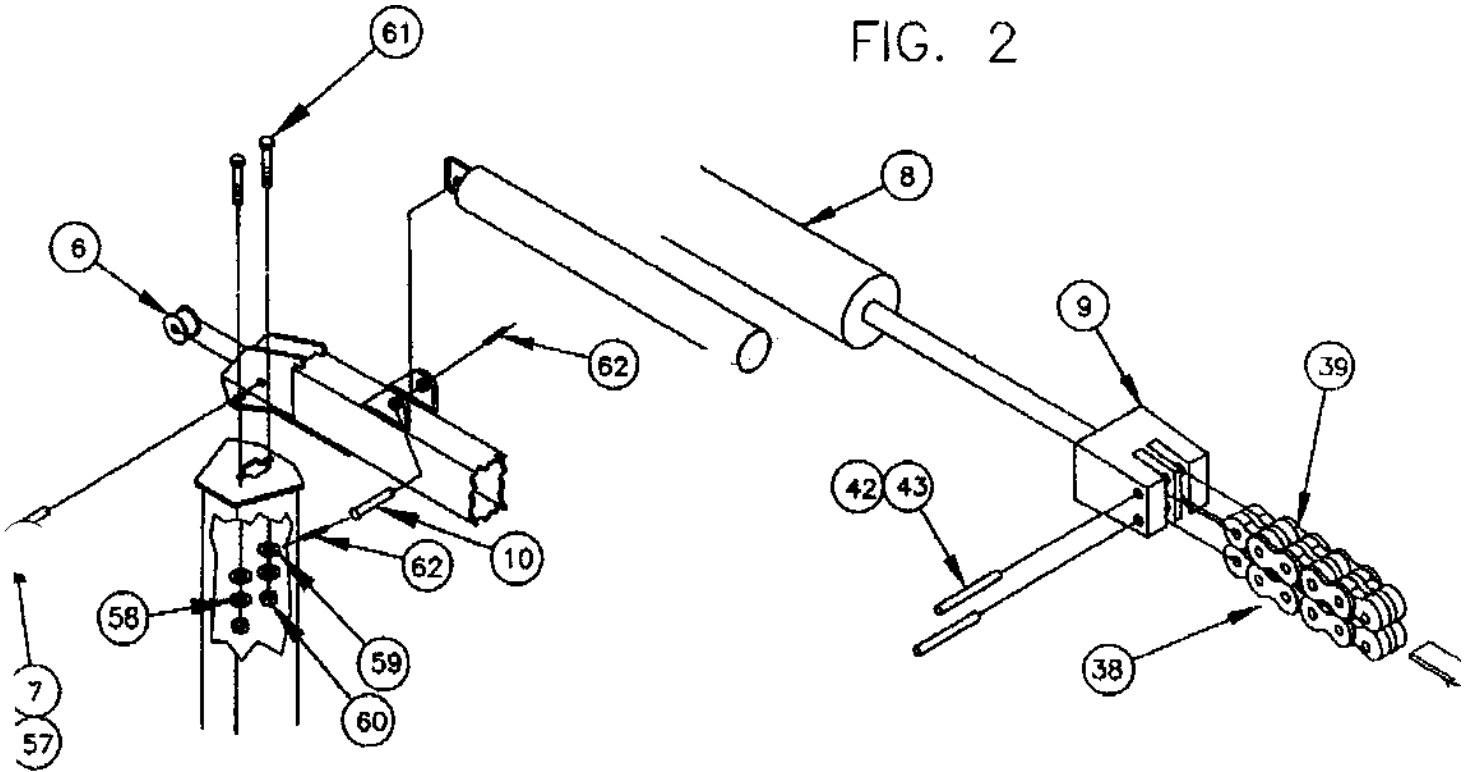

12-4MR

|    | MODEL                               | 12000-4 MR | 12000-4 MR S/N |
|----|-------------------------------------|------------|----------------|
|    | LIFT PART NUMBER                    | 90097      | QT             |
| 1  | POST STRUCTURE - MAIN P/U           | 91794      | 1              |
| 2  | POST STRUCTURE - MAIN REAR          | 91802      | 1              |
| 3  | POST STRUCTURE - OFFSIDE            | 91804      | 2              |
| 5  | HORIZONTAL BEAM STR.                | 91807      | 1              |
| 6  | SHEAVE ASSEMBLY                     | 91816      | 3              |
| 7  | SHAFT ASSEMBLY - UPPER, HORIZONTAL  | 91862      | 3              |
| 8  | CYLINDER                            | 91132      | 1              |
| 9  | CHAIN ANCHOR - CYLINDER             | 91776      | 1              |
| 10 | CYLINDER PIN                        | 91134      | 2              |
|    | CROSS TUBE ASSEMBLY - LEFT HAND     | 91930      | 1              |
|    | CROSS TUBE ASSEMBLY - RIGHT HAND    | 91952      | 1              |
| 11 | CROSS TUBE STRUCTURE LEFT ACTUATED  | 91931      | 1              |
| 12 | CROSS TUBE STRUCTURE RIGHT ACTUATED | 91929      | 1              |
| 14 | SPRING - RELEASE LOCK               | 91934      | 1              |
| 15 | BOLT - EYE                          | 91935      | 1              |
| 16 | PIVOT - RETURN SPRING               | 91936      | 1              |
| 17 | NYLOCK NUT                          | 101009     | 1              |
| 18 | SHEAVE ASSEMBLY - CROSS CHAIN       | 91825      | 2              |
| 19 | LATCH STRUCTURE, MANUAL RH          | 91990      | 1              |
| 65 | LATCH STRUCTURE, MANUAL LH          | 91991      | 1              |
| 20 | ARM STRUCTURE - LEFT ACTUATOR       | 91940      | 1              |
| 21 | HANDLE STRUCTURE - LEFT ACTUATOR    | 91943      | 1              |
| 22 | ARM STRUCTURE - RIGHT ACTUATOR      | 91947      | 1              |
| 23 | HANDLE STRUCTURE - RIGHT ACTUATOR   | 91948      | 1              |
| 24 | ROD - TIE                           | 91949      | 2              |
| 25 | END - YOKE, ADJUSTABLE              | 91950      | 2              |
| 26 | PIN - CLEVIS,                       | 91951      | 2              |
| 27 | PIN - COTTER,                       | 100175     | 2              |
| 28 | SHAFT ASSEMBLY - UPPER, CROSSMEMBER | 91864      | 4              |
| 29 | ANCHOR - LIFTING CHAIN              | 91775      | 1              |
| 30 | SPACER                              | 91859      | 2              |
| 66 | SPACER - SPRING                     | 91997      | 1              |
| 67 | RETAINER - EYE BOLT                 | 91998      | 1              |
| 31 | TRACK STRUCTURE                     | 91831      | 2              |
| 32 | BAR STRUCTURE - ADAPTER, RAMP       | 91839      | 2              |
| 33 | STOP - TRACK END                    | 91772      | 2              |
| #  | RAMP ASSEMBLY                       | 91865      | 2              |
|    | 34 RAMP STRUCTURE                   | 91850      | 2              |
|    | # TREAD PAPER                       | 56500      | 6              |
|    | 35 ROLLER RAMP                      | 91793      | 4              |
|    | 36 RETAINER                         | 91801      | 4              |
| 37 | PIN - HINGE, RAMP                   | 91792      | 2              |
| 38 | CHAIN - LONG SHORT                  | 91790      | 1              |
| 39 | CHAIN - SHORT                       | 91788      | 2              |
| 40 | CHAIN - CROSS SHORT                 | 91789      | 1              |
| 41 | ANCHOR - ADJUSTABLE                 | 91781      | 2              |
| 42 | PIN - CHAIN - LIFTING               | 91778      | 4              |
| #  | PIN - CHAIN - CROSSOVER             | 91779      | 4              |
| 43 | RETAINING RING                      | 103032     | 16             |
| 44 | ADAPTER                             | 60544      | 1              |
| 45 | ELBOW                               | 105004     | 1              |
| 46 | HYDRAULIC HOSE                      | 91860      | 1              |
| 47 | MALE ELBOW                          | 105049     | 2              |
| 48 | 3/8" TUBING - BLACK                 | 91861      | 1              |

**PANZITTA SALES & SERVICE**  
**72 George Avenue**  
**Wilkes-Barre, PA 18705**  
**570-822-6720 800-822-6720**  
**www.panzittasales.com**

WEST CORPORATION;

870 534 3177;

Dec-18-00 10:38AM;

Page 6/7

| #  | LIFT PART NUMBER              | 90097  | QT | 90133  | QT |
|----|-------------------------------|--------|----|--------|----|
|    | HARDWARW KIT - POWER UNIT     | 95009  | 1  | 95009  | 1  |
|    | 49 HHFL SCREW                 | 100234 | 4  | 100234 | 4  |
|    | 50 HH FL NUT                  | 100237 | 4  | 100237 | 4  |
| 51 | ANCHOR BOLT                   | 9500   | 16 | 9500   | 16 |
| 52 | SHIMS                         | 95001  | 24 | 95001  | 24 |
| 53 | POWER UNIT                    | 95011  | 1  | 95011  | 1  |
| 54 | SNAP RINGS                    | 103000 | 8  | 103000 | 8  |
| 55 | FLATWASHER                    | 100512 | 10 | 100512 | 10 |
| 56 | NYLOCK NUT                    | 101035 | 2  | 101035 | 2  |
| 57 | 1" SNAP RING                  | 103029 | 13 | 103029 | 13 |
| 58 | LOCKWASHER                    | 100125 | 20 | 100125 | 20 |
| 59 | FLATWASHER                    | 100152 | 36 | 100152 | 36 |
| 60 | HEX NUT                       | 100124 | 20 | 100124 | 20 |
| 61 | HEX SCREW                     | 100016 | 20 | 100016 | 20 |
| 62 | ROLL PIN                      | 103003 | 2  | 103003 | 2  |
| #  | KFR - 17 RELIEF VALVE         | 105028 | 1  | 105028 | 1  |
| #  | NAME PLATE                    | 62249  | 1  | 62249  | 1  |
| 64 | PLASTIC TIE                   | 103015 | 3  | 103015 | 3  |
| #  | BEN PEARSON DECAL             | 95005  | 2  | 95005  | 2  |
| #  | PB1800 DECAL 2 X 5 MYLAR      | 95006  | 1  | 95006  | 1  |
| #  | CAUTION DECAL                 | 95008  | 1  | 95008  | 1  |
| #  | MANUAL                        | 95085  | 1  | 95085  | 1  |
| #  | BLUE TOUCH-UP PAINT ( SPRAY)  | 103007 | 1  | 103007 | 1  |
| #  | YELLOW TOUCH-UP PAINT (SPRAY) | 103008 | 1  | 103008 | 1  |

**PANZITTA SALES & SERVICE**  
 72 George Avenue  
 Wilkes-Barre, PA 18705  
 570-822-6720 800-822-6720  
 www.panzittasales.com

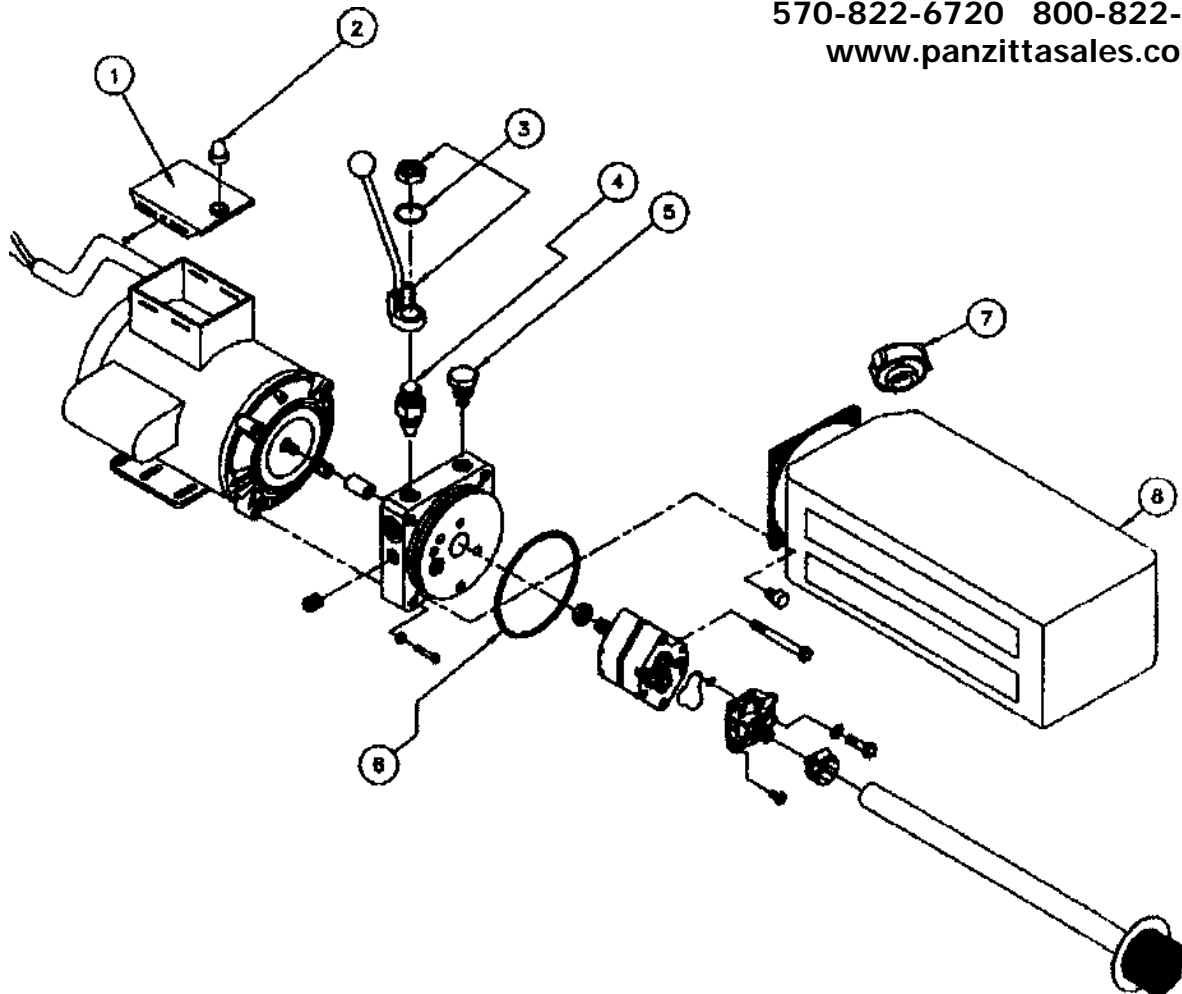

| ITEM NO. | DESCRIPTION             | PART # | QTY. |
|----------|-------------------------|--------|------|
| 1        | MICROSWITCH WIRING ASSY | 95086  | 1    |
| 2        | MICROSWITCH BOOT        | 95075  | 1    |
| 3        | MANUAL RELEASE ASSY     | 95041  | 1    |
| 4        | MANUAL RELEASE VALVE    | 95035  | 1    |
| 5        | VALVE CARTRIDGE CHECK   | 95036  | 1    |
| 6        | RESERVOIR O-RING        | 95076  | 1    |
| 7        | BREATHER                | 95044  | 1    |
| 8        | RESERVOIR               | 95040  | 1    |